

G-EYE escape

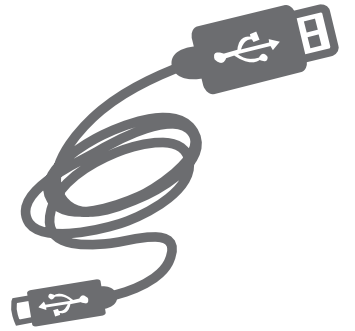

GEONaute

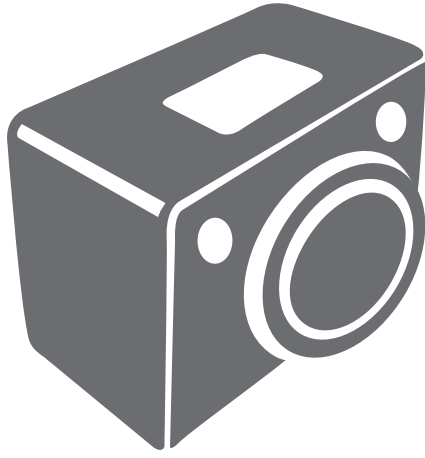



VIDEO CAMERA DESCRIPTION	2
GETTING STARTED.....	3
Insert battery.....	3
Charge.....	3
Insert micro-SD card	3
USING YOUR G-EYE.....	4
Power ON / OFF.....	4
Record a video	5
Take a photo	5
Camera functions overview	5
Default settings.....	6
CAMERA SETTINGS	7
Video settings	7
Photo settings	8
General settings.....	9
LASER POINTER	11
TRANSFER FILES ON COMPUTER.....	12
DISPLAY VIDEOS / PHOTOS ON TV/HDTV	12
ERROR MESSAGES	12
TECHNICAL FEATURES	13
PRECAUTIONS FOR USE.....	13
WARRANTY, LEGAL WORDING	14
Limited liability.....	14
warranty	14
Legal wording.....	14

VIDEO CAMERA DESCRIPTION

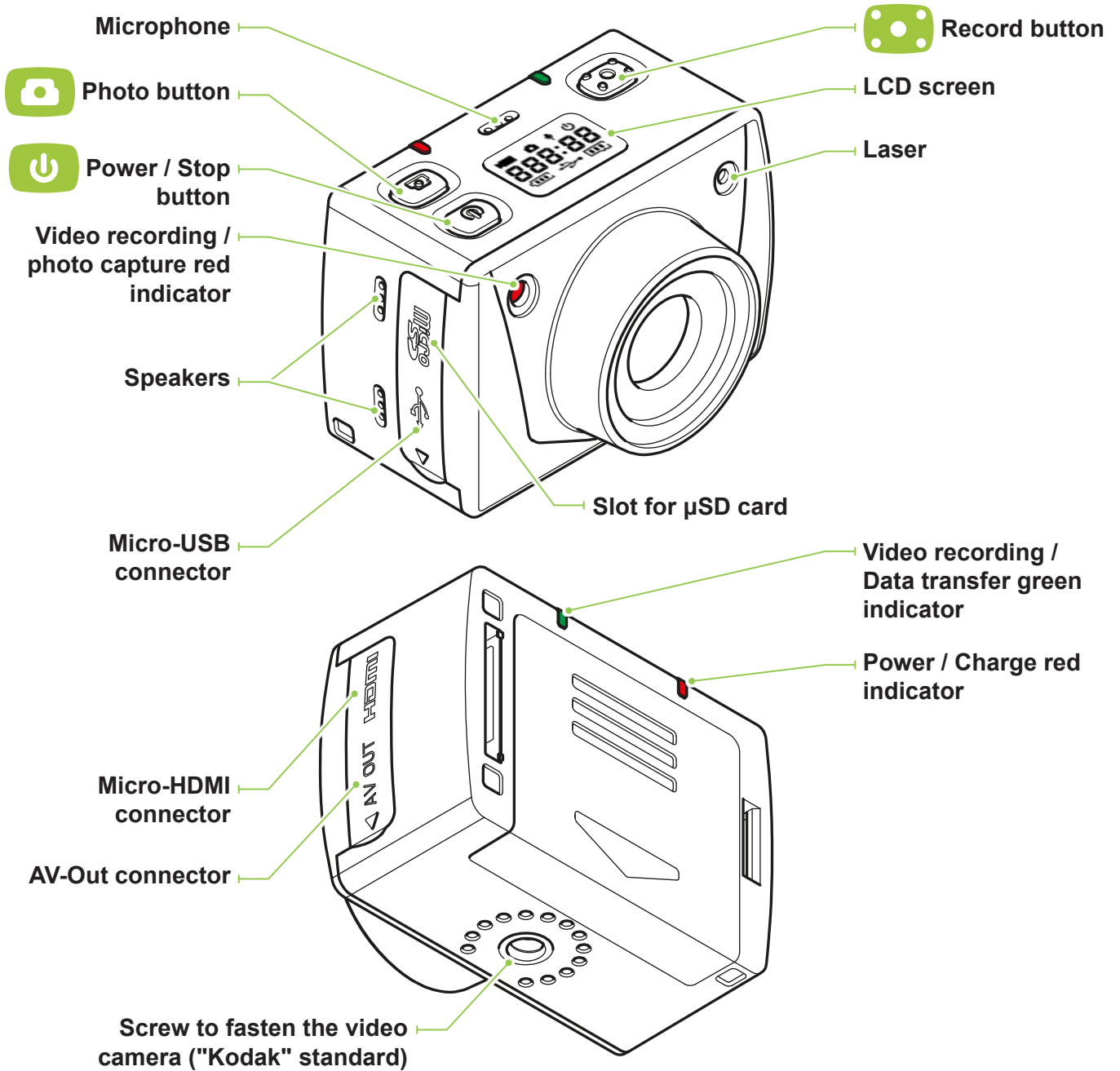

LCD SCREEN

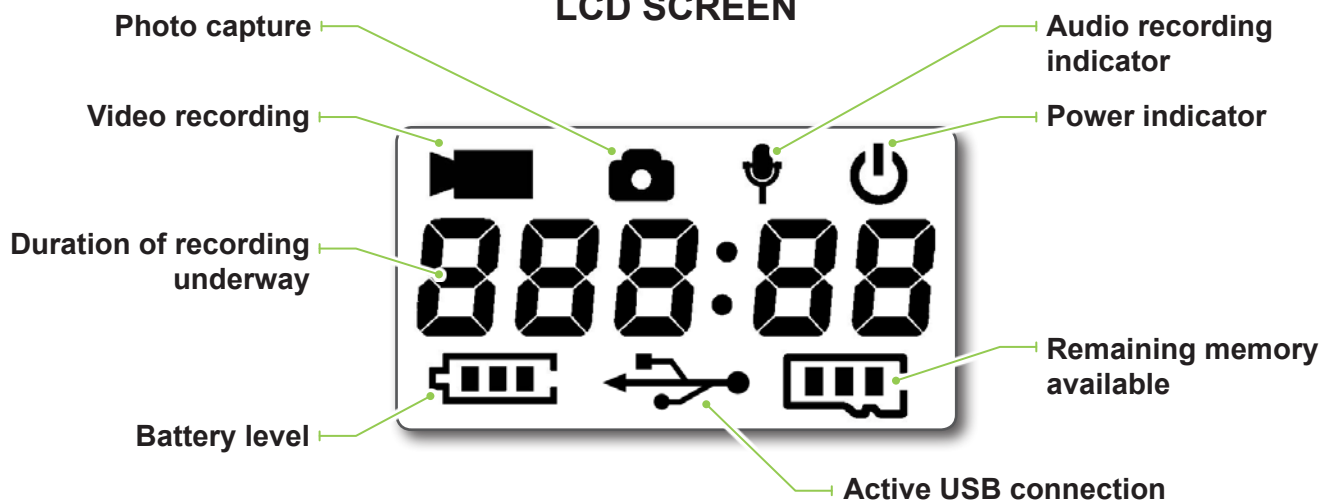

GETTING STARTED

INSERT BATTERY

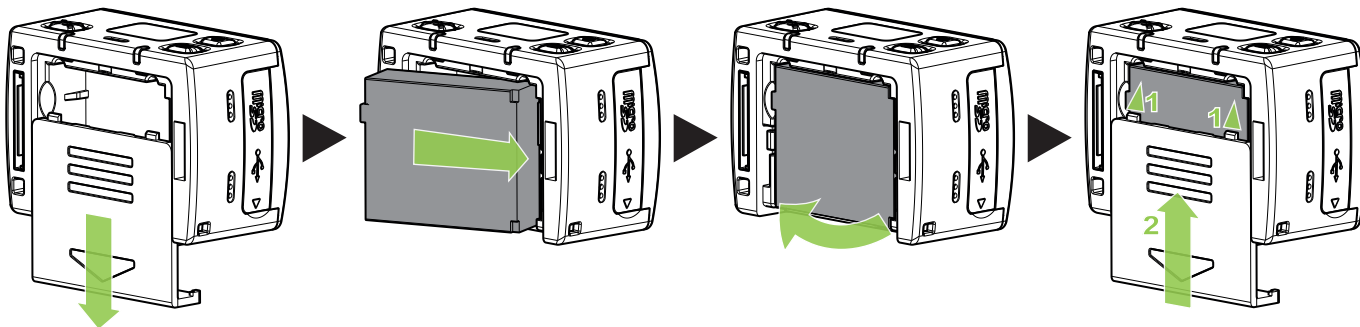

check that the battery is inserted in the right direction. Do not force it : it could damage the camera and make it unusable.

CHARGE

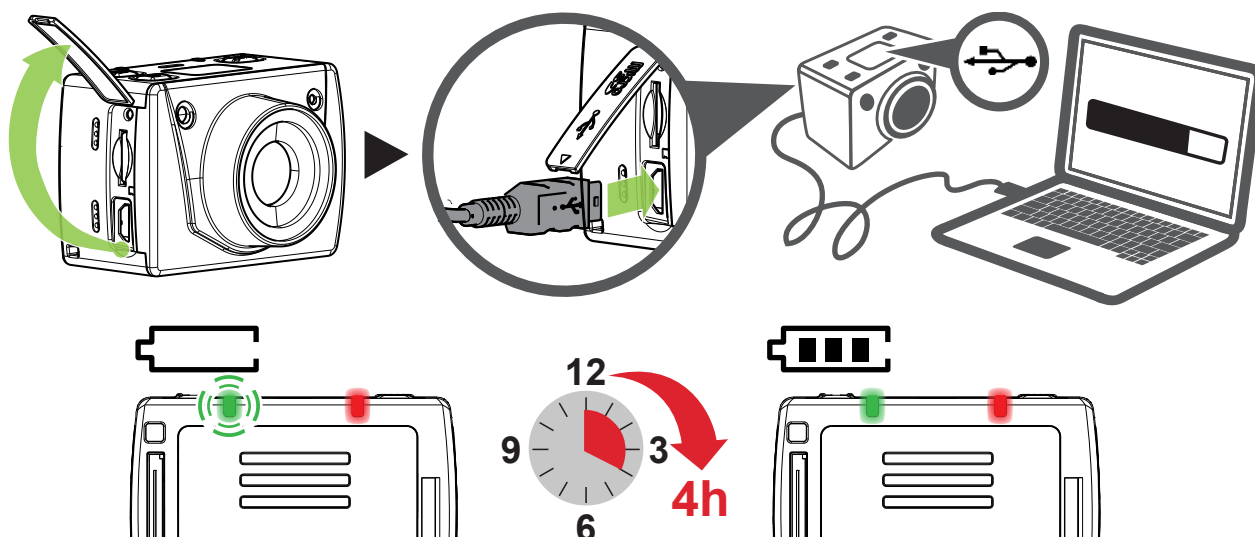

Fast Charging : When device is connected to computer, to have a more efficient charging process, you can make a long press on "power" button to shut down the camera. Then, the green LED will be powered off, and the red LED will be blinking during charging and stable when charge is completed. The charging time will be around 3 hours in that case. (Warning : data transfer is not possible during this charging mode).

INSERT MICRO-SD CARD

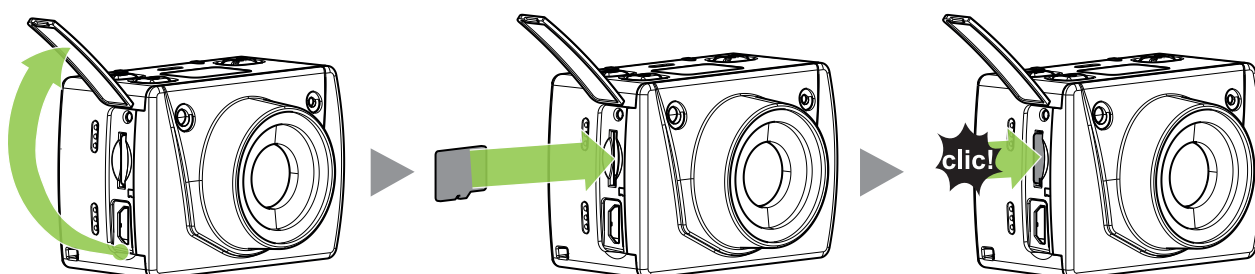

Compatible Cards

Micro-SD cards of 2GB to 32GB (Class 10 recommended)

USING YOUR G-EYE

POWER ON / OFF

POWER ON

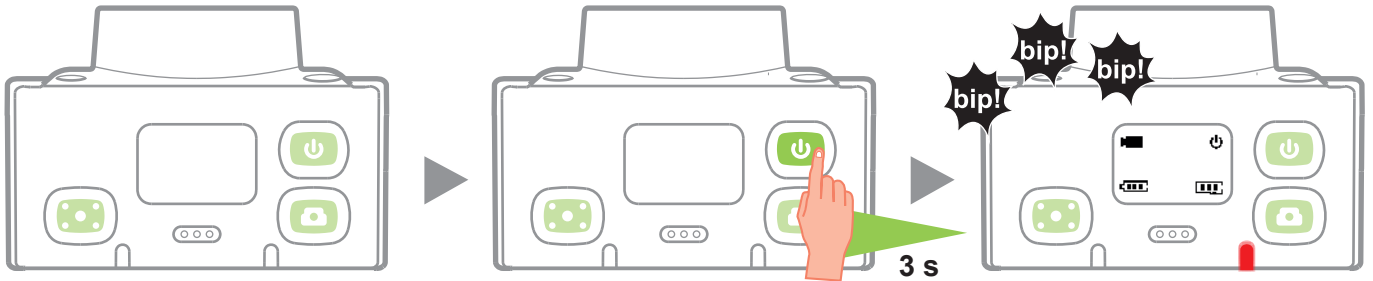

STANDBY

After 5 minutes without being used, the camera turns automatically to the standby mode.

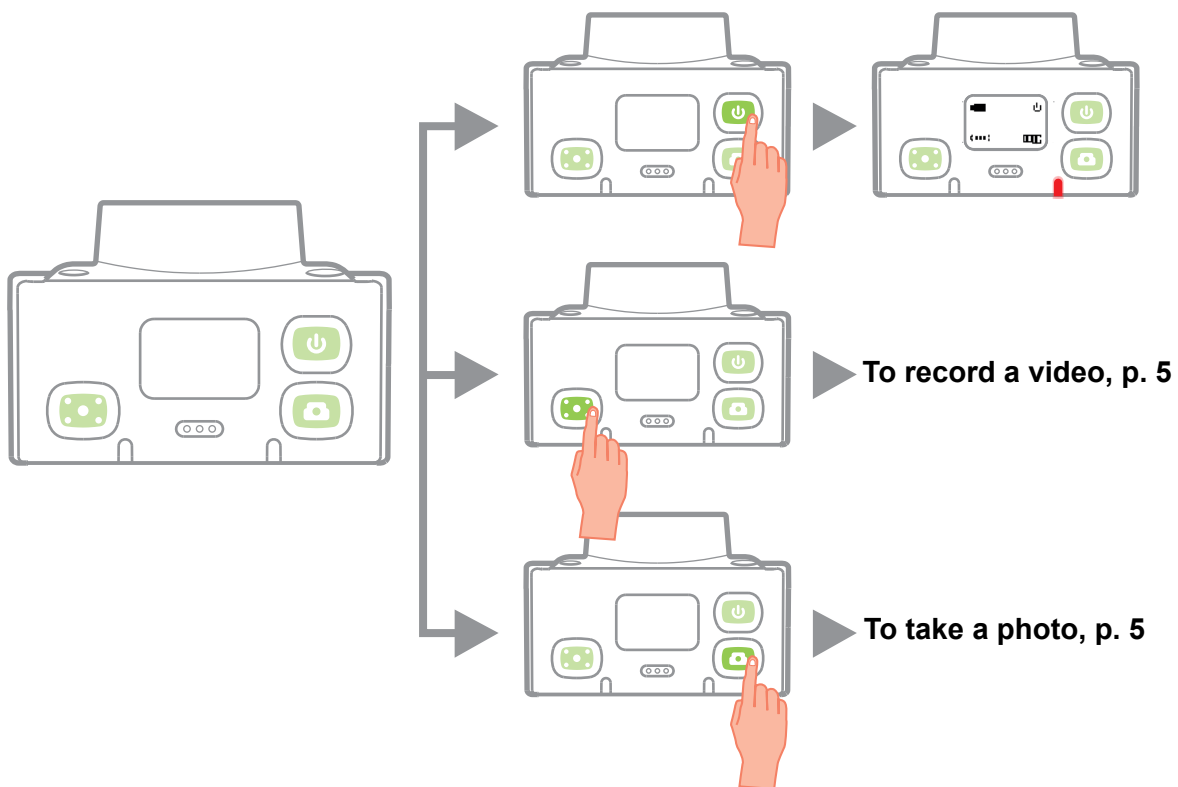

POWER OFF

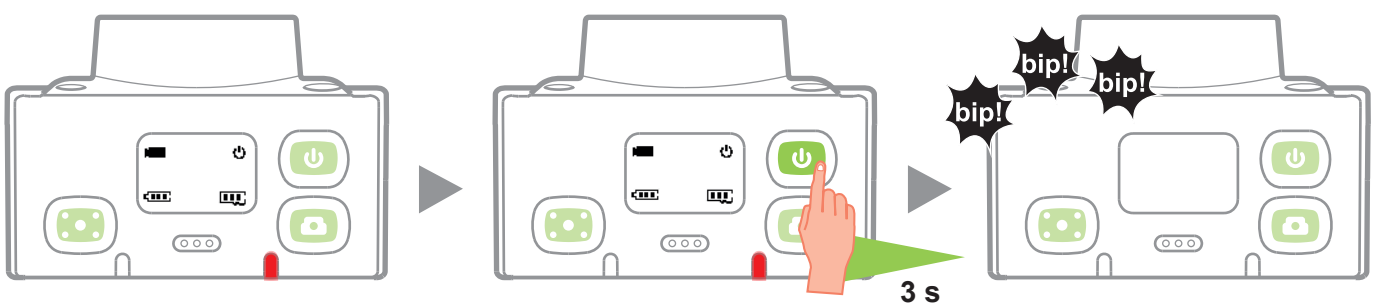

RECORD A VIDEO

START

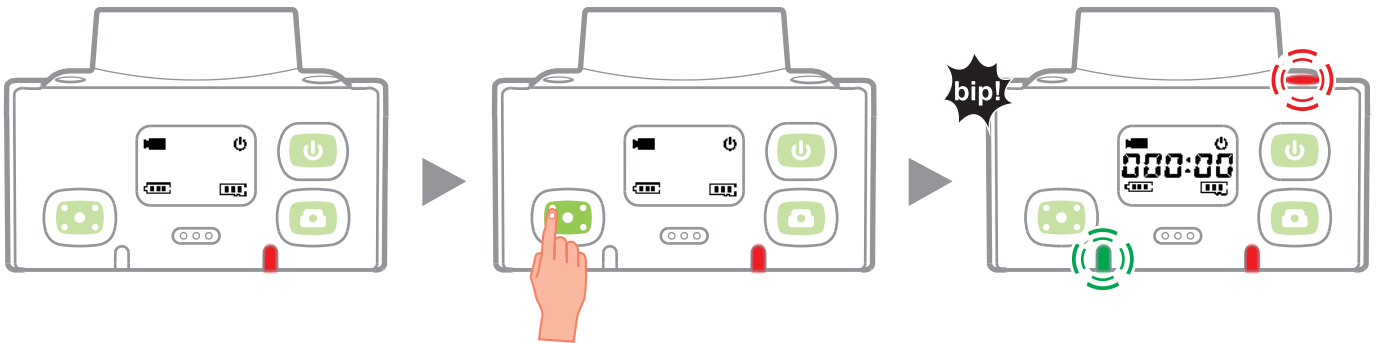

STOP

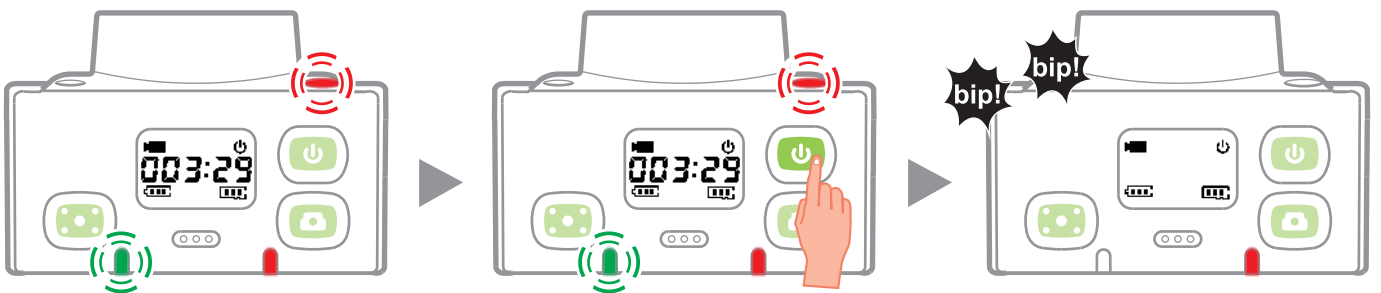

TAKE A PHOTO



CAMERA FUNCTIONS OVERVIEW

CAMERAS MODES

→ Burst mode	Page 8
→ Self timer	Page 8
→ Time lapse	Page 9

CAMERA SETTINGS

Video

→ Resolution	Page 7
→ Video bitrate	Page 7
→ Laser	Page 7
→ Video recording mode	Page 7

Photo

→ Resolution	Page 8
--------------	--------

General

→ Key beep	Page 10
→ Date and time display	Page 10
→ Continuous recording	Page 10
→ Automatic sleep mode	Page 10
→ TV standard	Page 10
→ Frame rate	Page 10
→ Date and time	Page 10

OTHER FUNCTIONS

→ Laser pointer	Page 7
→ Format memory	Page 10
→ Return to default settings	Page 10

DEFAULT SETTINGS

Video (Βίντεο)	Resolution	1920 x 1080 @ 30 fps
	Video bitrate	High video bitrate
	Laser	Off
	Video recording mode	Video + audio
Photo (Φωτό)	Single/triple shot mode	Single
	Timer	Off
	Time-laps	Off
	Resolution	2592 x 1944 / 5 megapixel
General (Σετάρ)	Beep	On
	Date and Time display	Off
	Continuous recording	Off
	Automatic sleep mode	After 5 min
	TV standard	PAL
	Frame rate	50 Hz
	Language	English





→ Return to default settings, see p. 10.

CAMERA SETTINGS

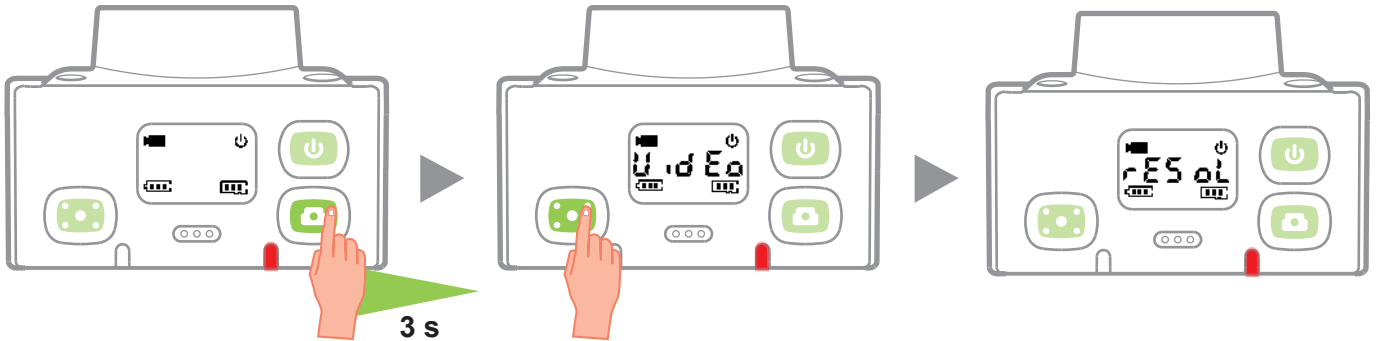
VIDEO SETTINGS

ACCESS TO VIDEO SETTINGS



- 1  Navigate in the settings menu
- 2  Enter in the setting
- 3  Scroll between the setting choices
- 4  Confirm the setting selection and return to upper menu

VIDEO SETTINGS LIST

SETTING	SETTING CHOICES	DETAILS
rESol Resolution	rES:1 1920 x 1080 30 fps, 16:9	
	rES:2 1280 x 720 60fps, 16:9	
	rES:3 1280 x 720 30fps, 16:9	
b it r t Video bitrate	b it:H i High video bitrate	High video bitrate will provide a higher definition of colours, but will use two times more memory space than in Low bitrate setting.
	b it:Lo Low video bitrate	
LASER Laser	OFF Disabled	
	ON Enabled	
	Aut o Automatic	The laser is automatically activated when you record a video, and stops when you stop recording.
Mod E Video recording mode	U id Eo Video and audio	
	Aud io Audio only	 is displayed.

-  Return to upper menu

PHOTO SETTINGS

ACCESS TO PHOTO SETTINGS

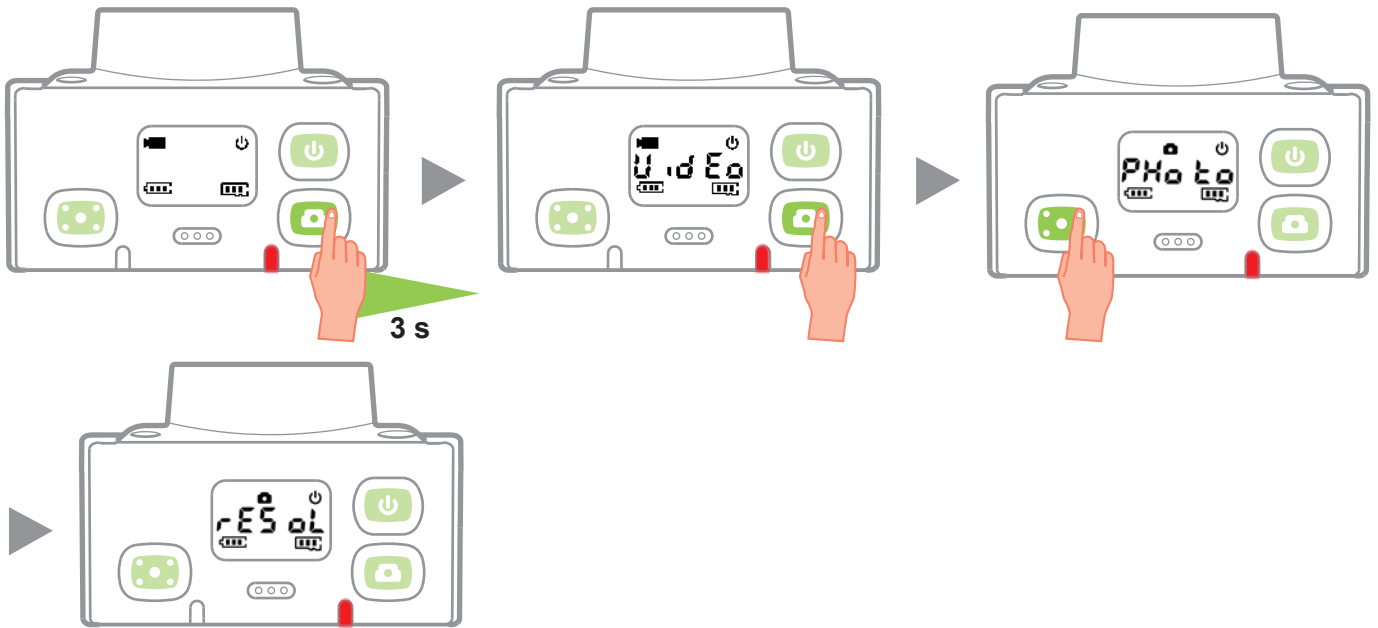





- 1  Navigate in the settings menu
- 2  Enter in the setting
- 3  Scroll between the setting choices
- 4  Confirm the setting selection and return to upper menu

PHOTO SETTINGS LIST

SETTING	SETTING CHOICES	DETAILS
RESOL Resolution	RES:8M 8MP, 4:3	3200 x 2400
	RES:5M 5MP, 4:3	2592 x 1944
	RES:3M 3MP, 4:3	2048 x 1536
Shot Shot mode	SINGLE Single-shot mode	In Burst Mode, the cameras takes 3 photos / second.
	BURST Burst mode	
TIMER Self-timer	OFF Disabled	When this function is activated, photos are taken after 5 s or 10 s delay.
	5 After 5 s	
	10 After 10 s	

SETTING	SETTING CHOICES	DETAILS
L-LAP Time lapse	LAP:0F Disabled	When this function is activated, the camera captures a series of photos at 2, 3, 5, 10, 20 or 30 seconds intervals.
	LAP: 2 2 seconds intervals	
	LAP: 3 3 seconds intervals	
	LAP: 5 5 seconds intervals	
	LAP: 10 10 seconds intervals	
	LAP:20 20 seconds intervals	
	LAP:30 30 seconds intervals	



Return to upper menu

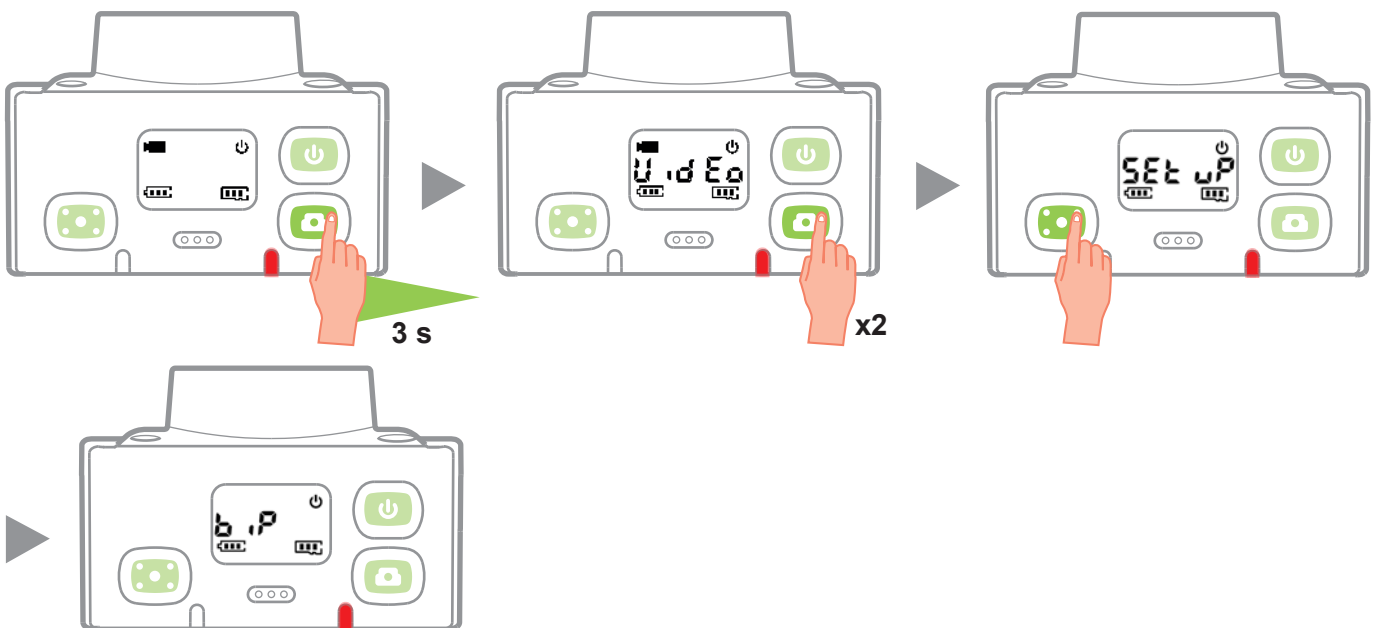

GENERAL SETTINGS

ACCESS TO GENERAL SETTINGS



- 1 Navigate in the settings menu
- 2 Enter in the setting
- 3 Scroll between the setting choices
- 4 Confirm the setting selection and return to upper menu

GENERAL SETTINGS LIST

SETTING	SETTING CHOICES	DETAILS
b .P Beep	b .P:On Enabled	Enable/Disable beeps on camera keys.
	b .P:OF Disabled	
StdbY Automatic sleep mode	Stb:OF Disabled	When this function is activated, the camera turns to standby mode after 2, 5 or 10 minutes.
	Stb: 2 After 2 mn	
	Stb: 5 After 5 mn	
	Stb: 10 After 10 mn	
t-d .S Date and time display	t-d:On Enabled	Enable/Disable overlay of date and time on video recording.
	t-d:OF Disabled	
Loop Continuous recording	Loop:On Enabled	When this function is activated, if the memory is full, the camera will delete the oldest video file to free memory space and continue recording. Deletion of files is repeated each time it's needed.
	Loop:OF Disabled	
For NR Format memory	YES Confirm	This function is used to erase all files saved on micro-SD card.
	nO Cancel	
dEL Et Delete files	YES Confirm	This function is used to delete selected files starting with the last saved file.
	nO Cancel	
rES Et Reset	YES Confirm	To return to default settings.
	nO Cancel	
tU TV standard	PAL PAL	
	nT SC NTSC	
HEr t2 Frame rate	H2:50 50 Hz	
	H2:60 60 Hz	
dAt E Date & Time	YER:yy Year	For each setting:  Increase the value  Decrease the value  Validate
	Mon:nn Month	
	dAY:dd Day	
	How:HH Time	
	n .m:nn Minute	



Return to upper menu

LASER POINTER

Laser pointer enables easy framing. It can be used with the optional waterproof cover.

ACTIVATE THE LASER POINTER

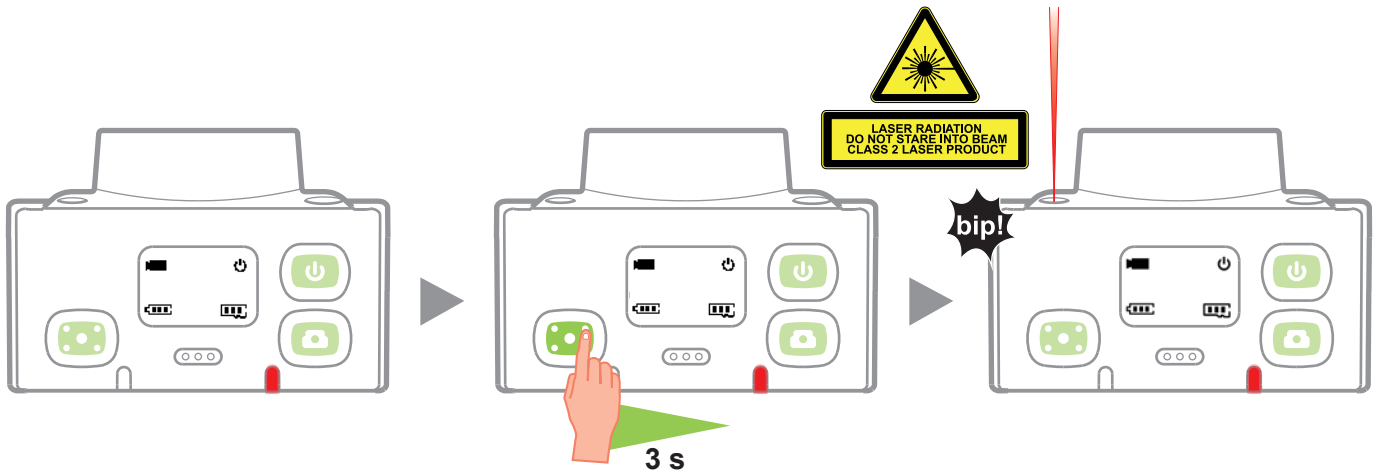

DEACTIVATE THE LASER POINTER

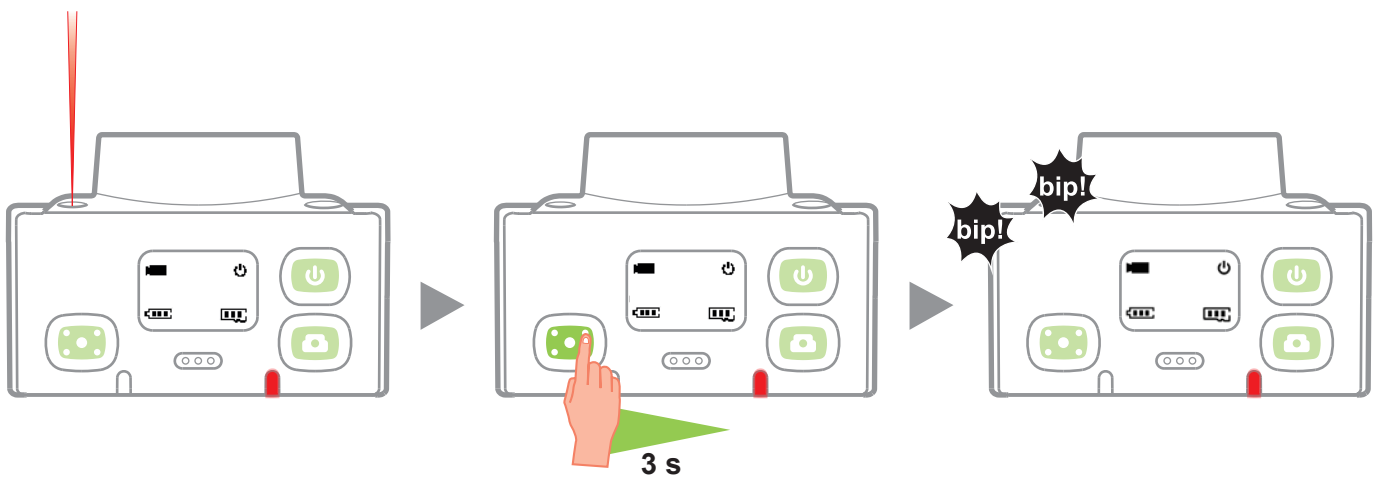

TRANSFER FILES ON COMPUTER

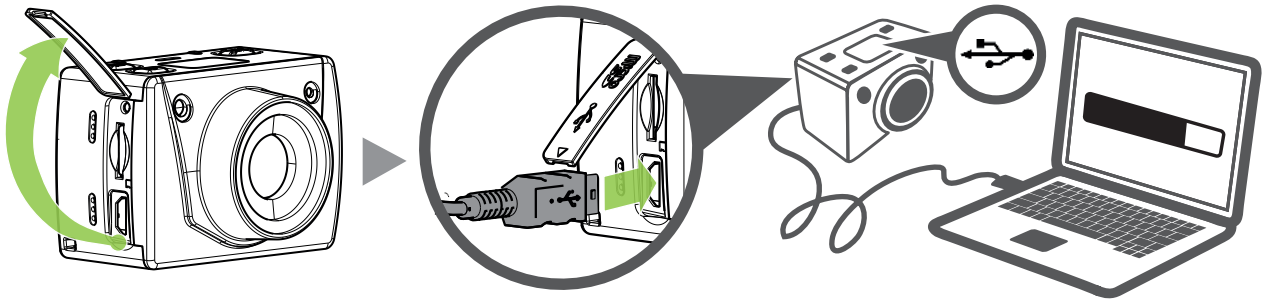

Next, recover files the same as you do with a USB key.

SYSTEM REQUIREMENTS

PC	MAC
Windows XP, Vista, 7, 8	OS > 10

DISPLAY VIDEOS / PHOTOS ON TV/HDTV

To see your videos and photos on a large screen, plug your G-EYE directly on a TV/HDTV with a HDMI/ micro HDMI, or with an AV-out cable (optional accessories). Refer to your TV instructions for use.

ERROR MESSAGES

MESSAGE	DESCRIPTION	ACTION
NO SD	No micro-SD card inside the camera: <ul style="list-style-type: none">Impossible to start recording/capture.Possible to go to «Settings» menu.	→ <i>Insert a micro-SD card in your camera, see p. 3</i>
FULL	Micro-SD card is full: <ul style="list-style-type: none">Impossible to start recording/capture.Possible to go to «Settings» menu.	→ <i>Transfer videos and photos on your computer, see p. 12.</i> → <i>Delete files, see p. 10.</i>
BAT LO	Low level of battery: <ul style="list-style-type: none">First, only the battery icon is blinking.The message is displayed 2 s before the camera turns OFF.	→ <i>Charge the battery, see p. 3.</i>

TECHNICAL FEATURES

Battery standby	Video continuous recording approximately 2 hours
Recharge time	~ 3.5 hours. Max < 4 hours
Battery type	Li-ion, 3.7V, 1000 mAh
Video resolution	1080p, 30fps, 16:9, viewing angle = 110° 720p, 60fps, 16:9, viewing angle = 135° 720p, 30fps, 16:9, viewing angle = 135°
Photo resolution	8MP, 5MP, 3MP
Connectors	Micro-USB, Micro-HDMI, AV-out, 32 pins for extensions
Connection to computer	USB 2.0 « Full-Speed », card reader Micro-SD
Micro-SD card compatible (sold separately)	Micro-SD of 2 GB to 32 GB
Operational temperature	-10°C < ... < 45°C
Video format	MP4
Photo format	JPG

PRECAUTIONS FOR USE



- Handle the device with care - do not drop it or subject it to strong impacts.
- This product is not waterproof, do not subject it to sprays of water or immerse it.
- For increased safety, avoid using the buttons during action. Loss of concentration can be dangerous
- Do not take the product apart, as this may lead to damage as well as cancellation of the warranty.
- Using the product in a very cold environment (temperature below -10°C) may lead to a reduction in battery capacity, and therefore reduction of battery lifetime.
- If you plan not to use the product over a long period of time (over 1 month), make sure the battery is removed.

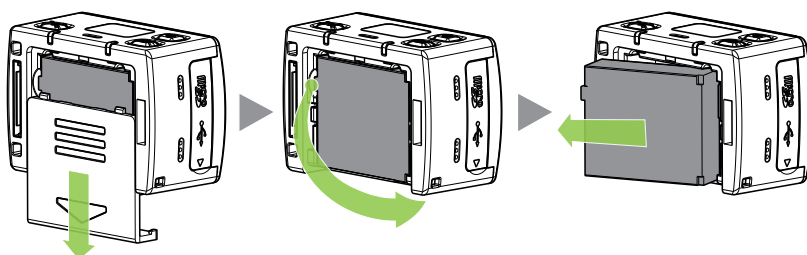

WARRANTY, LEGAL WORDING

LIMITED LIABILITY

- GEONAUTE is not responsible for accidents or injuries caused by handling or using the product during high risk sports.
- In particular, GEONAUTE insists on informing the user of possible loss of concentration linked to using the product in dangerous conditions.
- The user is warned that he assumes all legal liability for the taking, sharing, and publication of images recorded with the product.

WARRANTY

- GEONAUTE guarantees the initial buyer of this product that it is exempt of defaults related to the materials or fabrication and does so for a period of 2 years (inclusive) from the date of purchase.
- Please keep your receipt as proof of purchase.
- The warranty does not cover damage caused due to improper use, non-compliance with safety precautions, accidents, or the incorrect maintenance or commercial use of the device.
- This warranty does not cover damage resulting from repairs carried out by persons not authorised by GEONAUTE.
- The guarantees contained herein explicitly replace all other guarantees including the implicit guarantee of merchantability and/or suitability for use. GEONAUTE can, under no circumstances, be held responsible for any damage, direct or indirect, of a general or specific nature, caused by or related to use of these instructions or the product they describe.
- During the warranty period, the item will either be repaired free of charge by an authorised repair service or replaced free of charge (depending on the distributor).
- The warranty does not cover the battery, or camera if it is cracked, broken or presents visible dents.

LEGAL WORDING

CE COMPLIANCE

CE OXYLANE hereby declares that the G-EYE ESCAPE device complies with essential requirements and with other relevant stipulations of the 1999/5/CE directive.

The CE compliance declaration is available at the following web link:
<https://www.geonaute.com/en/ec-declaration-conformity>

RECYCLING



This product and the batteries it contains may not be thrown away with household waste. They are subject to a specific type of sorting. Take the batteries and unusable electronic product to an authorised collection area for recycling. This treatment of your electronic waste will protect the environment and your health.

CONTACT US

Contact us on www.geonaute.com.