

Front Derailleur (MTB)

INSTALLATION

1. Loosely attach the derailleur to the seat tube.
2. Position the derailleur so that the outer plate of the chain guide is directly above and parallel with the largest chainring, with 1 – 3mm clearance between the two. See Figure 1.
3. Securely tighten the front derailleur to 5 – 7Nm (44 – 60 in.lbs.).

LOW ADJUSTMENT

With the chain on the smallest front chainring and largest rear cog, turn the low adjustment screw until the clearance between the chain and the inner plate of the chain guide is 0 – 0.5mm. See Figure 2.

CABLE INSTALLATION

Route the inner cable from the shift/brake lever to the front derailleur. Pull the cable tight to remove slack and secure the cable fixing bolt. See Figure 3. Grab the cable along the underside of the down tube (Down-pull cable route) or grab the cable from top of seat tube (Top-pull cable route) and pull on it to stretch it. Then loosen the cable fixing bolt, pull the cable tight once again and secure it by tightening the cable fixing bolt to 5-7Nm.

HIGH ADJUSTMENT

With the chain on the largest chainring and smallest rear cog, turn the high adjustment screw until the clearance between the chain and the outer plate of the chain guide is 0 – 0.5mm. See Figure 4.

CABLE TENSION ADJUSTMENT

1. If the chain does not drop from the largest to smallest chainring during a downshift, loosen the knurled cable adjusting barrel (see Figure 5) ¼ turn at a time to decrease cable tension.
2. If the chain does not climb from the smallest to largest chainring during an upshift, tighten the knurled cable adjusting barrel ¼ turn at a time to increase cable tension.

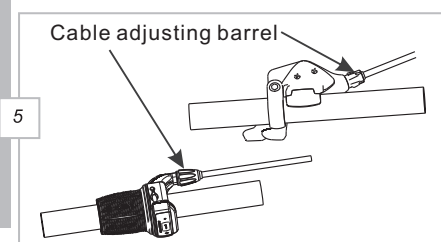
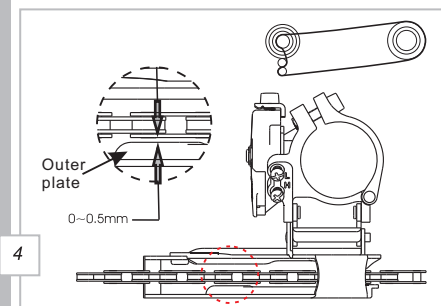
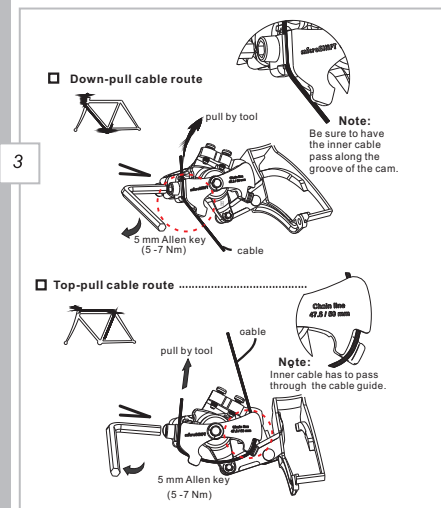
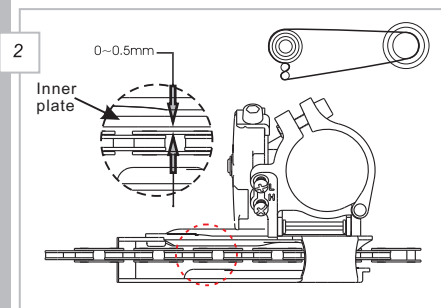
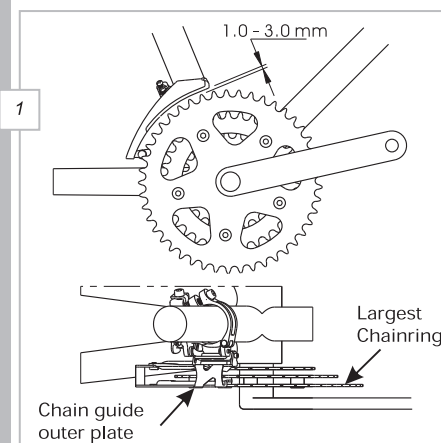

Rear Derailleur (MTB)

INSTALLATION

1. Attach the derailleur to the rear frame dropout or derailleur hanger. See Figure 1a.
2. Be careful that the B-tension adjustment screw does not contact the dropout tab in a way that would cause deformation. See Figure 1b.
3. Secure the derailleur attachment bolt to 8 – 10Nm (70 – 86 in.lbs.).

HIGH ADJUSTMENT

Turn the “H” adjustment screw until the derailleur guide pulley is centered directly beneath the outer edge of the smallest cog. See Figure 2.

CABLE INSTALLATION

Route the inner cable from the shift/brake lever to the rear derailleur. Pull the cable tight to remove slack and secure the cable fixing bolt. Be sure the cable is properly positioned under the cable fixing bolt washer (see Figure 3).

Grab the cable along the underside of the down tube and pull on it to stretch it. Then loosen the cable fixing bolt, pull the cable tight once again and secure it by tightening the cable fixing bolt to 5 – 7Nm (44 – 60 in.lbs.).

LOW ADJUSTMENT

Shift to the largest rear cog and turn the “L” adjustment screw until the derailleur guide pulley is centered directly beneath the largest cog. See Figure 4.

B-TENSION ADJUSTMENT

With the chain on the smallest chainring and largest rear cog, turn the crank backwards. Turn the B-tension adjustment screw to bring the guide pulley as close as possible to the large cog without touching it. Next, move the chain to the smallest rear cog and adjust the B-tension screw to bring the guide pulley as close as possible to the small cog without touching it. See Figure 5.

