



EN

ONwalk 100

GEONAUTE

1 First set-up

1.1. Switching on



1.2 Setting your height



Setting your height enables automatic calculation of your length of stride. The length of stride can also be set manually in the settings menu.

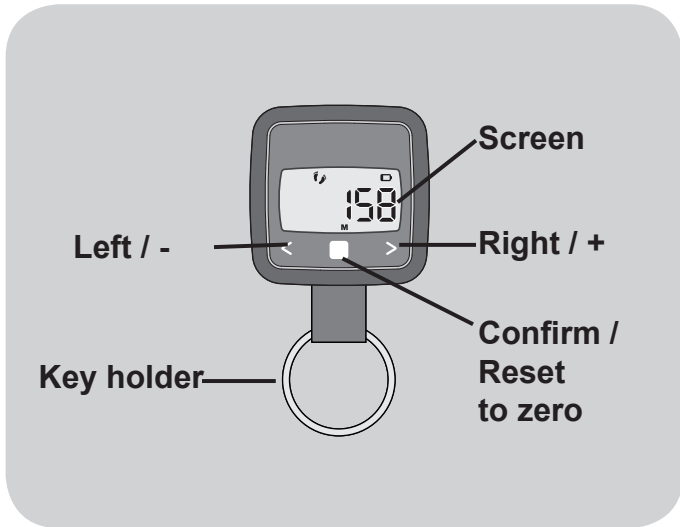

2 Settings

2.1 Setting procedure

Confirm < > increase/decrease the values

You can leave the settings menu at any time and return to the main menu by pressing the ■ button for 1.5 seconds.

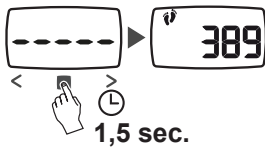

2.2 Setting your stride length

By default, your stride length is calculated according to your height. If you wish to customise your stride length, please go to „Manu” mode

To find out your stride length, walk 10 metres while counting the number of steps then do this calculation: stride length = 10 metres / number of steps.

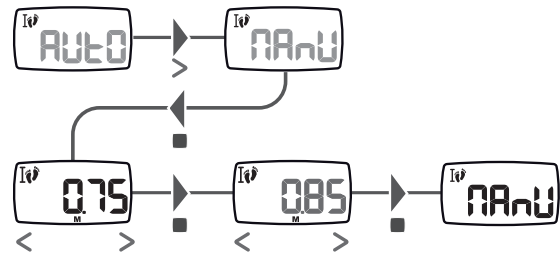

3 Use

3.1 Positioning the product



3.2 Viewing the information



3.3 Starting the measurement

Your pedometer starts to measure automatically when you start walking.

3.4. Resetting to zero

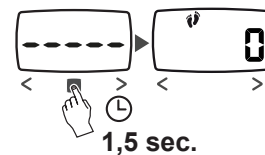

3.5 Automatic standby

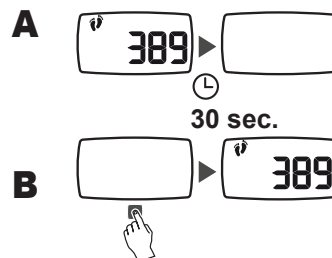

4 Changing the battery

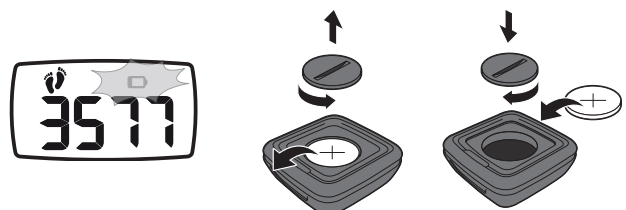



The algorithms used to calculate the different values displayed by your pedometer have been developed for walking and brisk walking only. The accuracy of these values will be severely reduced if used when running. Therefore, we do not recommend using this product for running.



To change the battery: contact the retail outlet where you bought your product. If you change it yourself, you risk damaging the seal and impairing the waterproof design as well as voiding your warranty. Battery life is influenced by the length of time it is stored in the shop and the way in which you use the product.

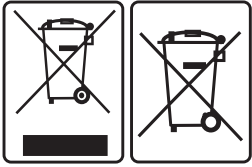

The «crossed-out bin» symbol means that this product and the batteries it contains must not be thrown away with general household waste. They are subject to a specific type of sorting. Please take the batteries and your unusable electronic product to an authorised collection point for recycling. This treatment of your electronic waste will protect the environment and your health. Dispose of your batteries in a place where they will be recycled.

The product has a 2 years guarantee for normal usage.

The guarantee does not cover :

- damage resulting from misuse, from a failure to respect the precautions for use, from accidents, from improper maintenance or from commercial use of the product.
- damage resulting from repairs carried out by persons not authorised by **DECATHLON**.
- batteries and casings which are cracked or broken or which show signs of impacts.

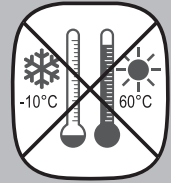
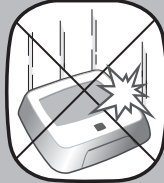

Made in Malaysia
Fabricado na Malásia
Произведено в Малайзии
İmal edildiği yer Malezya
马来西亚 制造
馬來西亞製造

合格品

迪脉（上海）企业管理有限公司
上海市浦东新区银霄路393号五层东侧

IMPORTADO PARA BRASIL POR IGUASPORT LtdaCNPJ : 02.314.041/0022-02

Импортер: ООО "Октобл", 141031, Россия, Московская область, Мытищинский район, МКАД 84-й км., ТПЗ "Алтуфьево", владение 3, строение 3.

台灣迪卡儂有限公司台灣台中市408南屯區大墩南路379號諮詢電話: (04) 2471-3612

TURKSPORT Spor Ürünleri Sanayi ve Ticaret Ltd.ŞtiOsmaniye Mahallesi Çobançeşme KoşuyoluBulvarı No: 3 Marmara Forum Garden Office 0B Blok 01 Bakırköy 34146 İstanbul, TURKEY

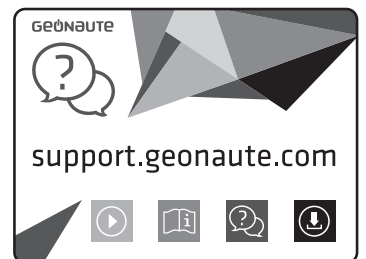

GEONAUTE.COM

DECATHLON

DECATHLON

4 Boulevard de Mons – BP 299
59665 Villeneuve d'Ascq cedex – France

Ref. pack: 650.550

