



Owner's manual ref. 1615.371

GEONAUTA

GEONAUTA

AR | TR | BG | SV | CS | SK | RO | RU | HU | PL | PT | NL | IT | DE | ES | FR | EN

On channel 100



X2



X6

On channel 300

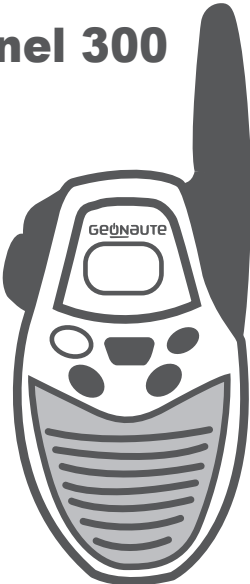

X2

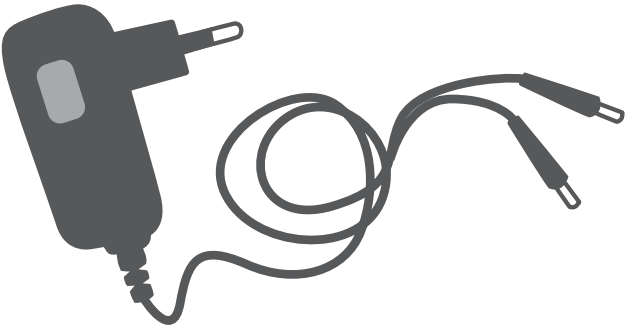

X6

1	PRECAUTIONS FOR USE.....	2
2	DESCRIPTION	3
3	GETTING STARTED.....	5
3.1	Using the batteries (On channel 100).....	5
3.2	Using the batteries (On channel 300).....	6
3.2.1	Inserting the batteries.....	6
3.2.2	Charging the batteries.....	6
3.3	Recycling the batteries.....	7
3.4	Installing / removing the belt clip.....	7
4	TRANSMITTING AND RECEIVING.....	8
4.1	Transmission range.....	8
4.2	Switching on the device.....	8
4.3	Signal transmission power (On channel 100).....	9
4.4	Configuring the channel.....	9
4.4.1	Setting the channel.....	9
4.4.2	Channel monitoring.....	9
4.4.3	Scan function: channel scanning.....	10
4.5	Listening and ringer volume.....	10
4.6	Lock / Unlock.....	10
4.7	Call function.....	11
4.8	Switching the device off.....	11
5	USING THE LIGHT (ON CHANNEL 100).....	11
6	TECHNICAL CHARACTERISTICS	12
6.1	Specifications.....	12
6.2	Channel frequency table.....	12
7	CE DECLARATION OF CONFORMITY	12
8	WARRANTY	13
9	CONTACT US.....	13

1 PRECAUTIONS FOR USE



- Please read the owner's manual carefully before use. Please keep the owner's manual for the entire life of the product.
- To reduce radio frequency exposure when using the device, keep it at least 5 cm away from your face.
- Do not allow babies or young children to get near the devices.
- Never use a walkie-talkie with a damaged antenna. If the antenna is in contact with the skin, mild burns may result.
- When using the device in a vehicle, do not leave it in the area above an airbag or in the airbag deployment area because it can be propelled with great force and cause serious injury to the vehicle occupants if the airbag is deployed.
- The devices are designed to be used in temperatures ranging from -10°C to +50°C inclusive.
- If the devices are used in low temperatures, you must use batteries capable of standing up well to low temperatures. Preferably use lithium or NiMH rechargeable batteries as alkaline and zinc batteries perform very badly in low temperatures.
- Do not use the devices or change the batteries in an explosive atmosphere. The antenna or batteries can produce micro-sparks or static electricity which can set off explosions causing serious injury and even death.
- Never use the device outside during a storm.
- Do not use the device in the rain.
- If the device gets wet, switch it off and remove the battery. Dry the battery compartment and leave the cover open for a few hours. Do not use the device until it is completely dry.
- Do not dismantle the product. This will void the warranty and could cause damage or loss of watertightness.
- Clean the product with a soft, moist cloth or a compressed air canister. Never use detergents as they could cause damage to the materials. Do not rub the screen with anything that might scratch it.
- Remove the batteries before storing the device for a prolonged period.

2 DESCRIPTION

On channel 100

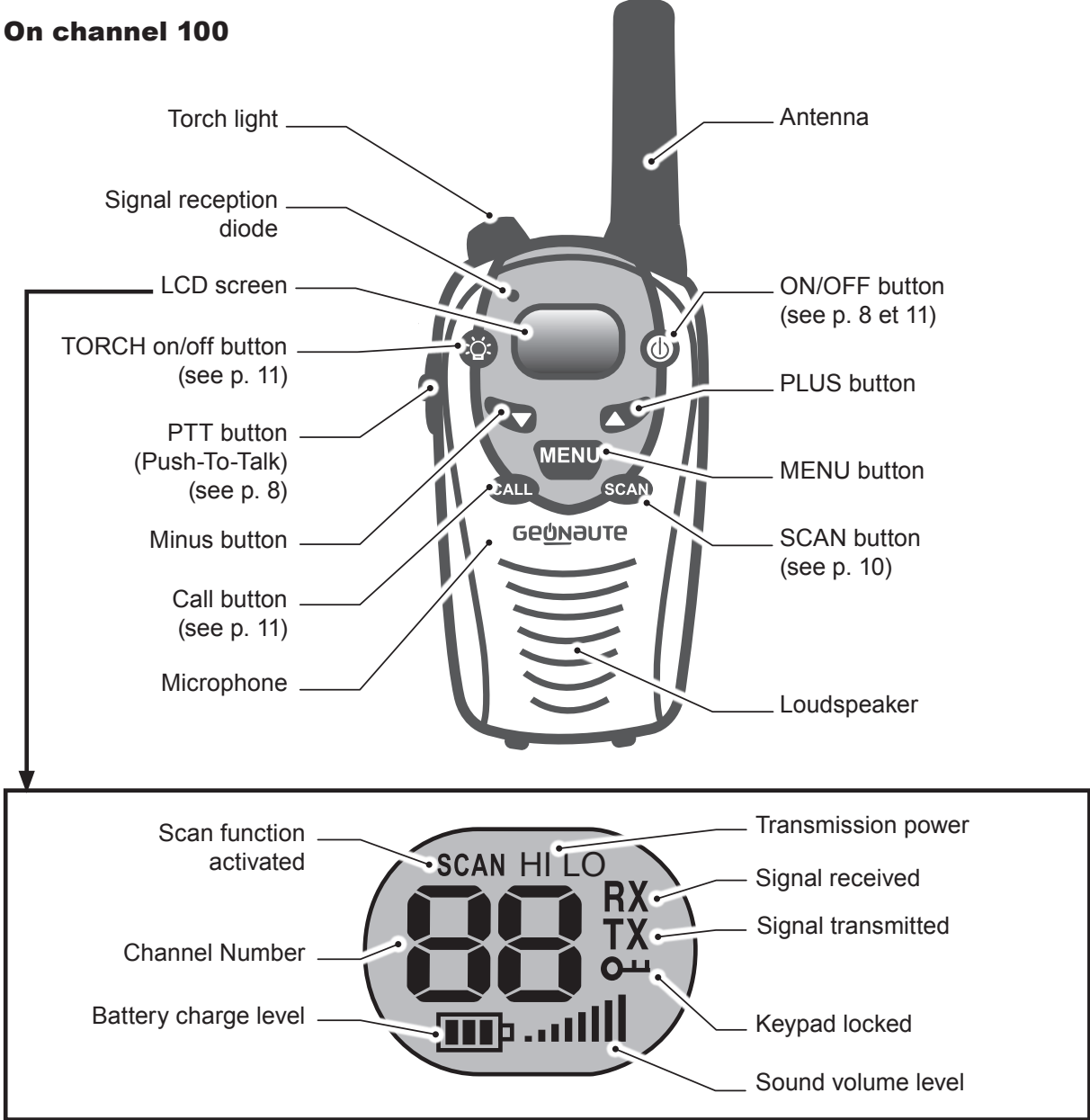

On channel 300

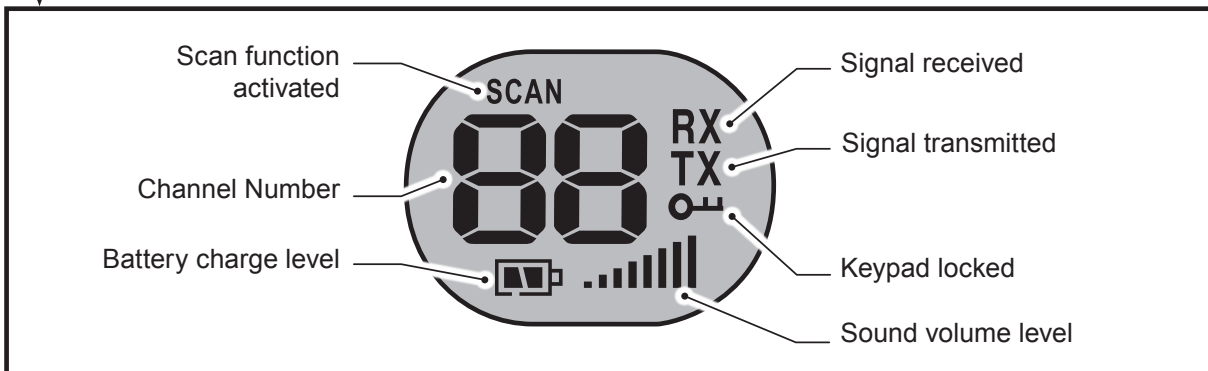
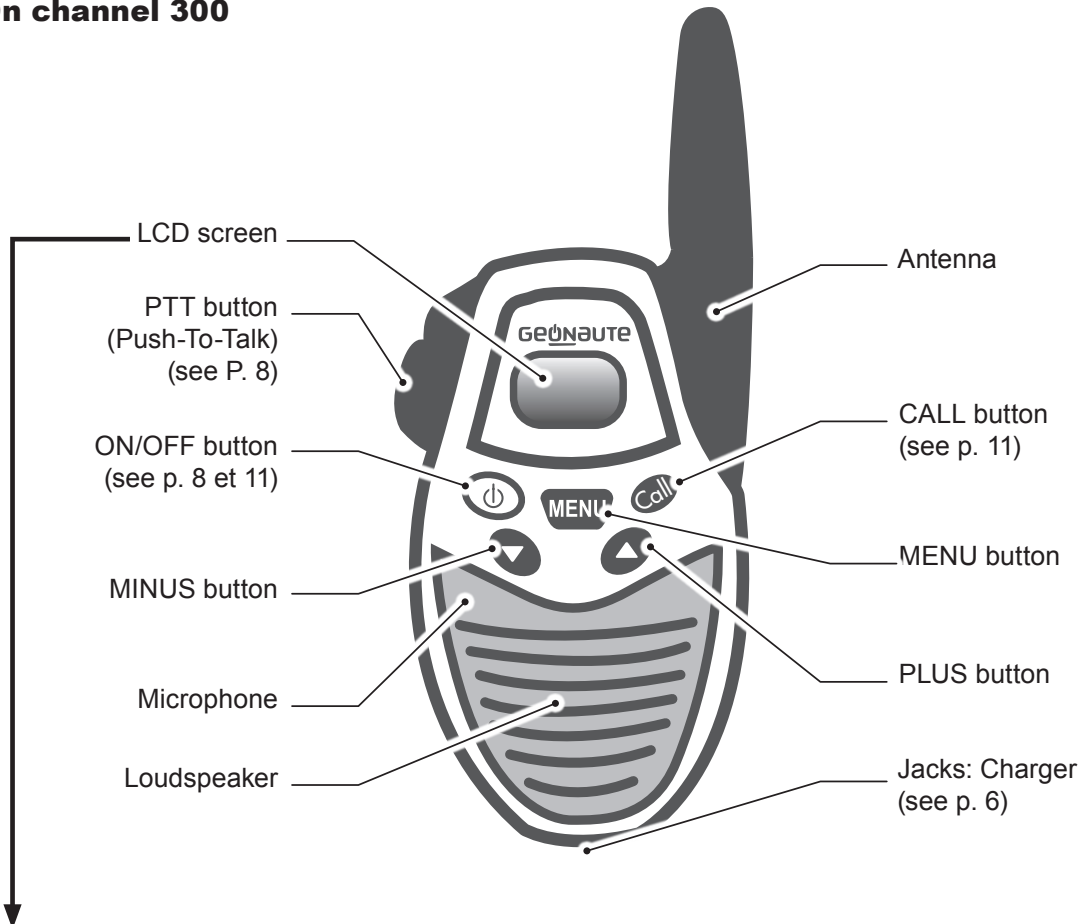

3 GETTING STARTED

3.1 Using the batteries (On channel 100)

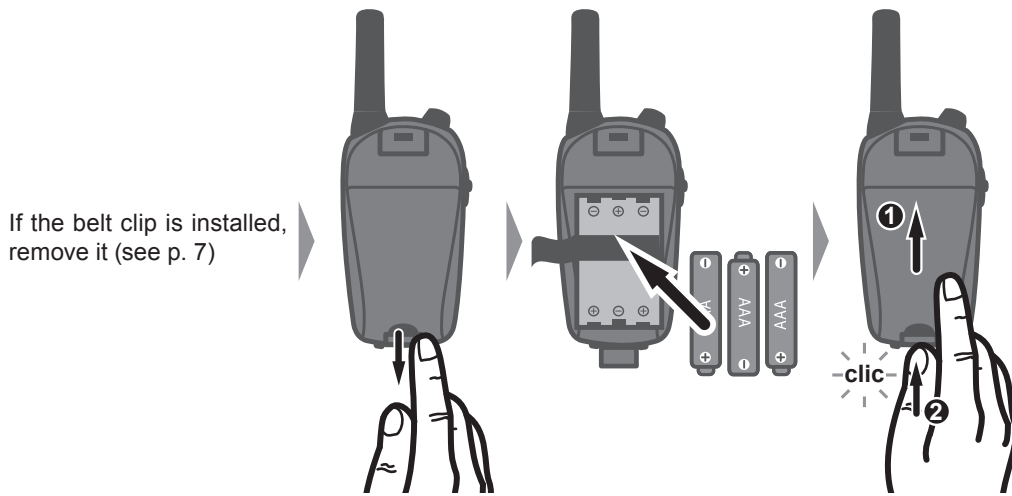

If the belt clip is installed, remove it (see p. 7)



Observe the correct direction when inserting the batteries. Incorrect polarity can damage the batteries and the device.



- Use the batteries provided in the original pack. If the batteries have to be changed, use 1.5V AAA (LR03) type Alkaline batteries.
- Never mix alkaline and rechargeable batteries.
- Do not attempt to recharge non-rechargeable batteries.

Battery charge level

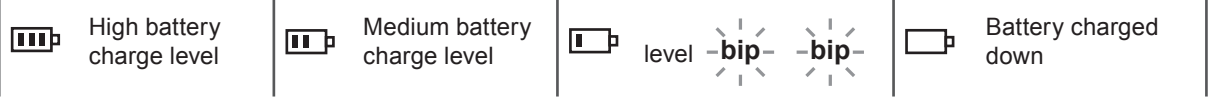

3.2 Using the batteries (On channel 300)



The batteries come ready installed when the product is purchased. Remove the protective strip located on the back of the device to free up the battery contacts.

3.2.1 Inserting the batteries

If the belt clip is installed, remove it (see p. 7)

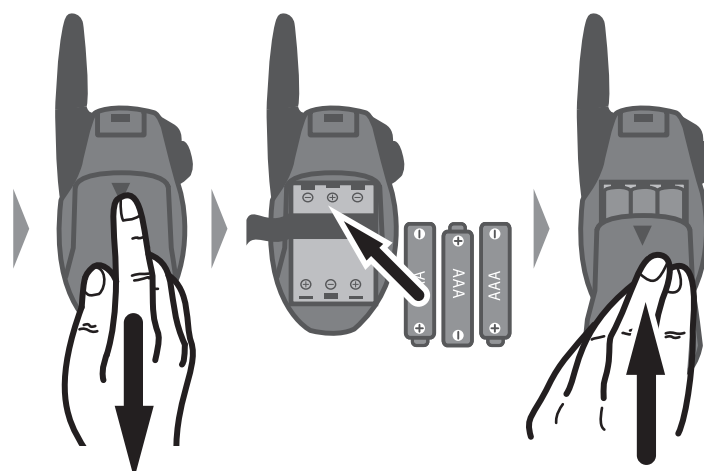

Observe the correct direction when inserting the batteries. Incorrect polarity can damage the batteries and the device.

3.2.2 Charging the batteries



- When charging the device, use the rechargeable batteries supplied with the original pack. If the batteries have to be changed, use 1.2V, 600 mAh NiMH AAA (LR06) type batteries.
- Do not attempt to recharge non-rechargeable batteries.
- Make sure that the battery compartment is correctly in place before charging the batteries.

Battery charge level (displayed when the device is switched on)



High



Low

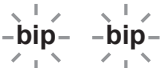

-bip-

The batteries must only be charged with the battery charger provided.



- You can charge 2 devices at the same time. Battery charging time is approximately 12 hours. We recommend that you charge the batteries fully before using them for the first time.
- When the device is charging, no communication is possible.
- To extend the time between recharges and prolong the life of the batteries, they should be discharged completely, then fully recharged once a month.

3.3 Recycling the batteries

Do not leave spent batteries in the device as they may leak and cause damage to device's internal circuits.

The 'crossed-out dustbin' symbol indicates that this product and the batteries it contains cannot be disposed of with household waste. They are subject to specific sorting. The product and batteries must be recycled at a collection point at end of life. Recycling your electronic waste protects the environment and your health.

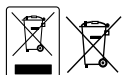

3.4 Installing / removing the belt clip

INSERTING

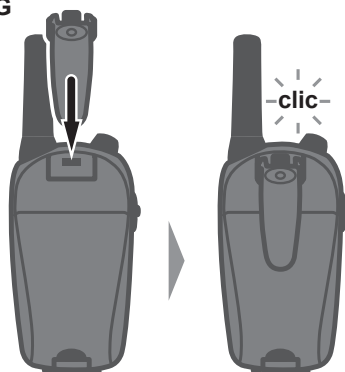

REMOVING

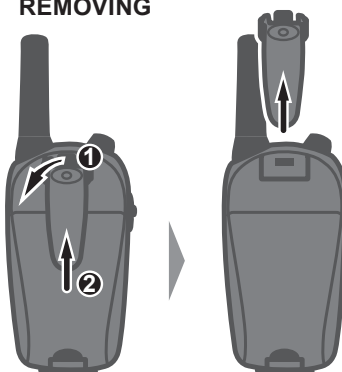

4 TRANSMITTING AND RECEIVING

4.1 Transmission range

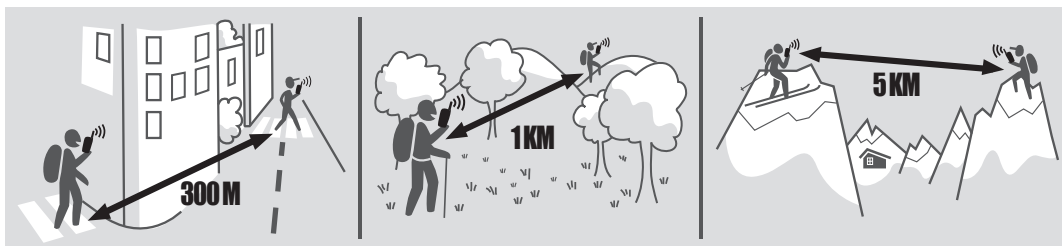

- To optimise the transmission range, there should be as few obstacles as possible (including users) in the imaginary line drawn between the two devices.
- Interference can occur if you use the devices less than 1.5 m apart.

4.2 Switching on the device

With the On channel 100 / 300, you can communicate with another On channel 100 / 300 unit or any other PMR 446 standard transmitter / receiver. In conference mode, you can also communicate with an unlimited number of PMR 446 devices.

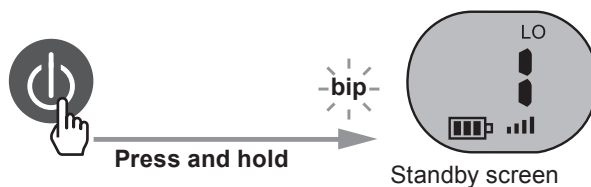

- All the devices must be set to the same channel for them to communicate with each other (see p. 9).
- Communication takes place in alternate mode: if another device is transmitting, you must wait for the end of its transmission before transmitting. Similarly, communications cannot be received during transmission or when the Call function is active (see p. 11).

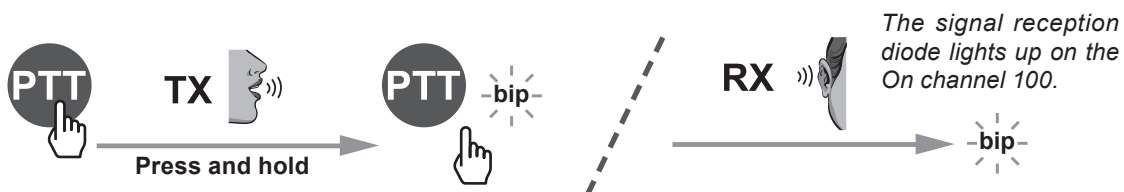



If no buttons are pressed for 8 seconds when configuring the device, the standby screen will be displayed automatically and any changes made will be saved.

4.3 Signal transmission power (On channel 100)

When the transmission power is high (H), the signal emitted is strong. This is especially useful when the correspondents are close to maximum transmission range. When the transmission power is low (L), the signal emitted is less powerful but there is less risk of interference and the sound quality of the communication is higher.

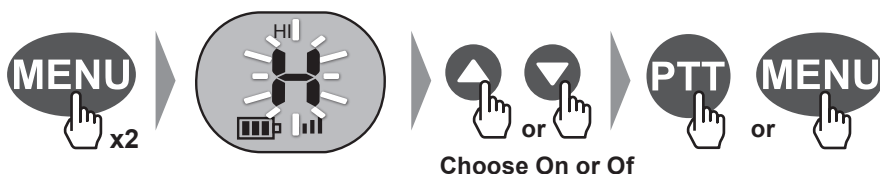

4.4 Configuring the channel

The On channel 100 / 300 can communicate over one of 8 available channels.

4.4.1 Setting the channel

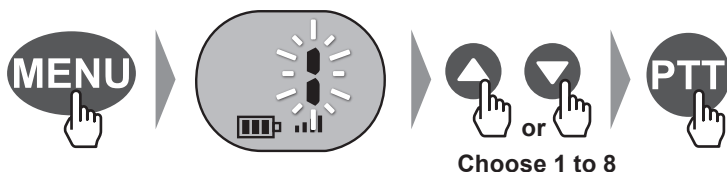

4.4.2 Channel monitoring

With this function you can listen to all signals (even the weakest) on the channel that you are using.

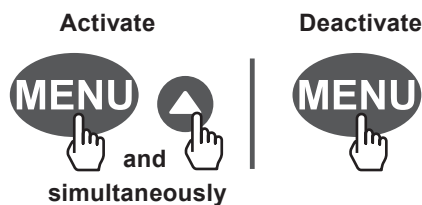

4.4.3 Scan function: channel scanning

This function allows you to scan all 8 channels to identify which one is being used by your correspondents.

On channel 100

Activate

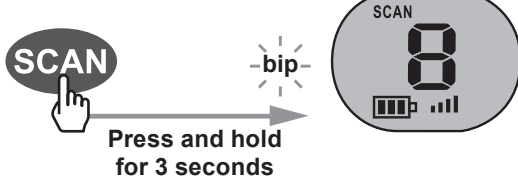

Deactivate

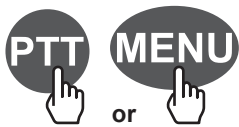

On channel 300

Activate

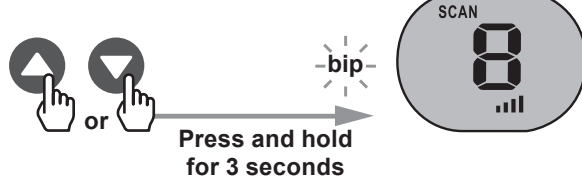

Deactivate

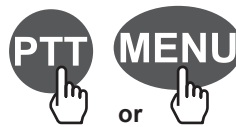

- When the device detects a signal, scanning stops and the unit communicates on the channel in question.
- Scanning is automatically restarted a few seconds after signal reception stops.

4.5 Listening and ringer volume

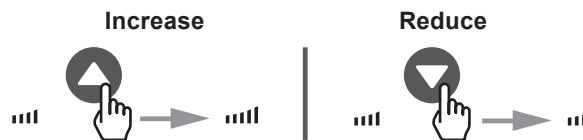

4.6 Lock / Unlock

On channel 100



On channel 300

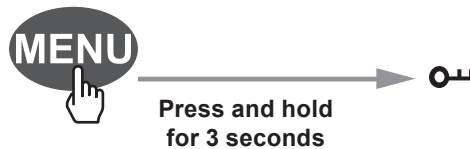

4.7 Call function

The CALL button rings all the devices using the same channel for 2 seconds.

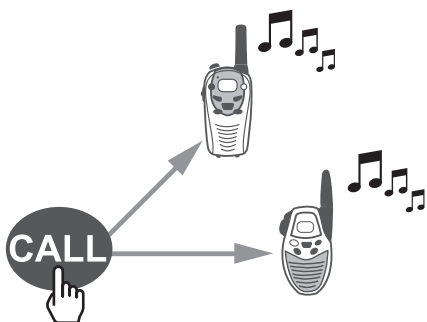

4.8 Switching the device off

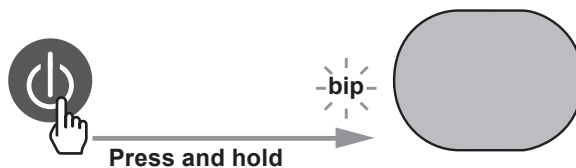

We recommend that you switch off the device when not in use to prevent the batteries from running down completely.

5 USING THE LIGHT (ON CHANNEL 100)



The light will work even if the device is switched off.

6 TECHNICAL CHARACTERISTICS

6.1 Specifications

Available channels	8 channels
Output power (TX)	0.5 W
Range	Up to 5 Km

6.2 Channel frequency table

Channel	Frequency (MHz)	Channel	Frequency (MHz)
1	446.00625	5	446.05625
2	446.01875	6	446.06875
3	446.03125	7	446.08125
4	446.04375	8	446.09375

7 CE DECLARATION OF CONFORMITY

- Oxlane hereby declares that the On channel 100 device complies with the essential requirements and other relevant provisions of Directive 1999/5/CE
- Oxlane hereby declares that the On channel 300 device complies with the essential requirements and other relevant provisions of Directive 1999/5/CE
- Oxlane hereby declares that the On channel 300 device complies with the essential requirements and other relevant provisions of Directive 2006/95/CE.

Compliance with these required conditions is expressed by the marking: 

The CE declaration of conformity is available via the following link:
<https://www.geonaute.com/en/ec-declaration-conformity>

8 WARRANTY

Oxylane guarantees to the initial purchaser of this product that it is free from material or manufacturing defects. This product is guaranteed for two years from the date of purchase. Please ensure that you keep the invoice as proof of purchase.

The guarantee does not cover:

- Damage resulting from misuse, from a failure to respect the precautions for use, from accidents, from improper maintenance or from commercial use of the product.
- Damage resulting from repairs carried out by persons not authorised by Oxylane.
- Batteries or casings which are cracked or broken or which show signs of impacts.

During the warranty period, the item will either be repaired free of charge by an authorised repair service or replaced free of charge (depending on the distributor).

9 CONTACT US

We would like to hear your views on the quality, features and use of our products at: www.geonaute.com

We will reply as soon as possible.

GEONAUTÉ.COM

oxylane

OXYLANE

4 Boulevard de Mons – BP 299

59665 Villeneuve d'Ascq cedex – France

