

G-EYE discover

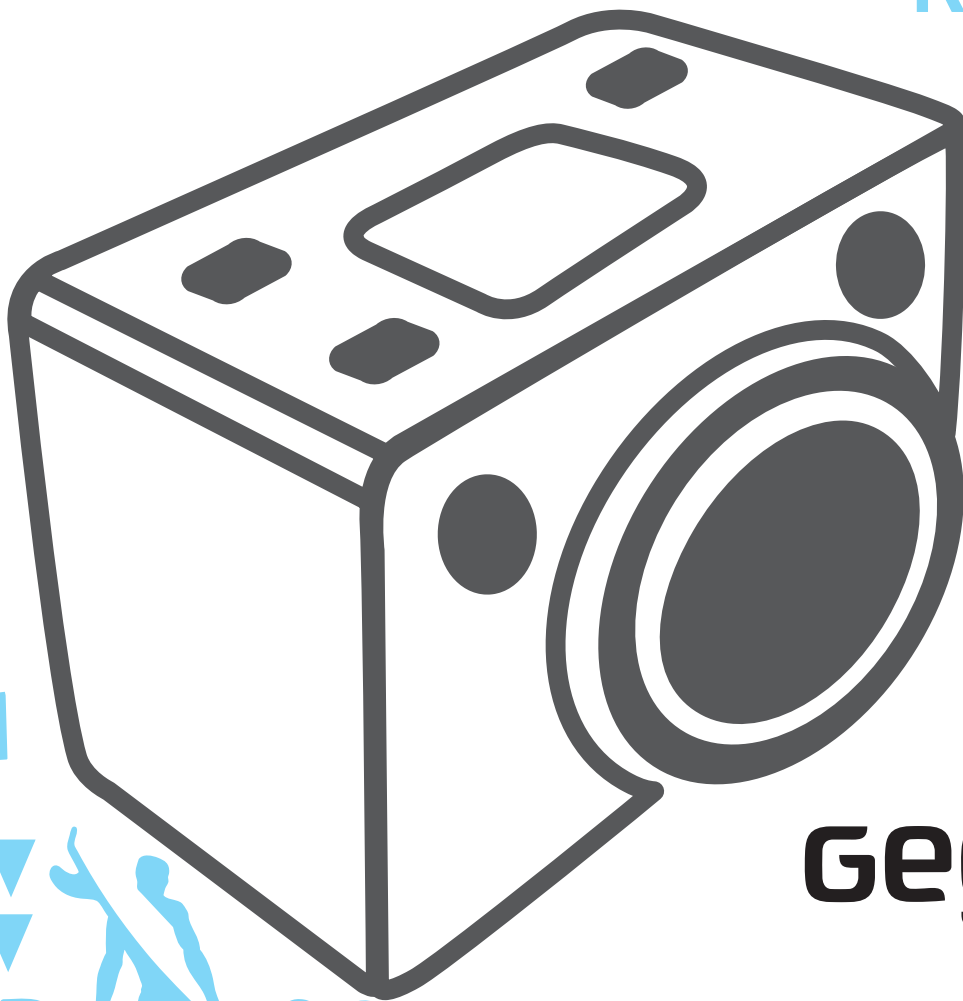

WASH

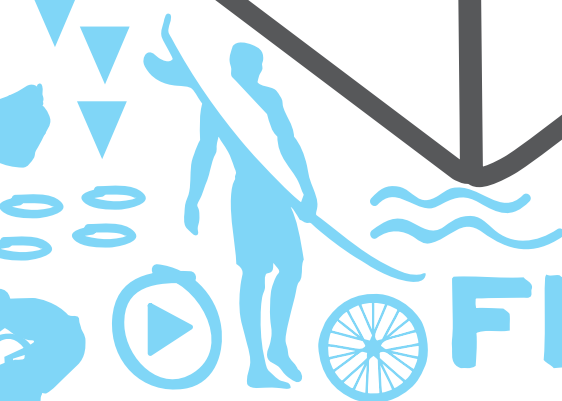

GEONAUTE

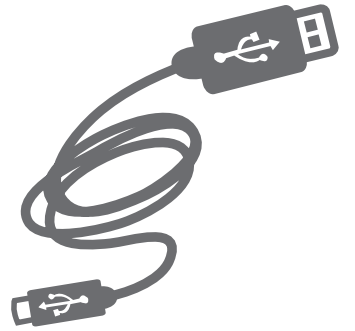
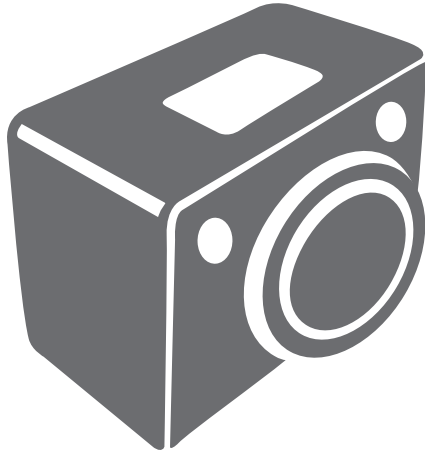

VIDEO CAMERA DESCRIPTION	2
GETTING STARTED.....	3
Charge.....	3
Insert micro-SD card	3
USING YOUR G-EYE.....	4
Power ON / OFF	4
Record a video	5
Take a photo	5
DATE AND TIME SETTING	6
LASER POINTER	6
TRANSFER FILES ON COMPUTER.....	7
RESET	7
ERROR MESSAGES	8
TECHNICAL FEATURES	8
PRECAUTIONS FOR USE.....	9
WARRANTY, LEGAL WORDING.....	9
Limited liability.....	9
warranty	9
Legal wording.....	10

VIDEO CAMERA DESCRIPTION

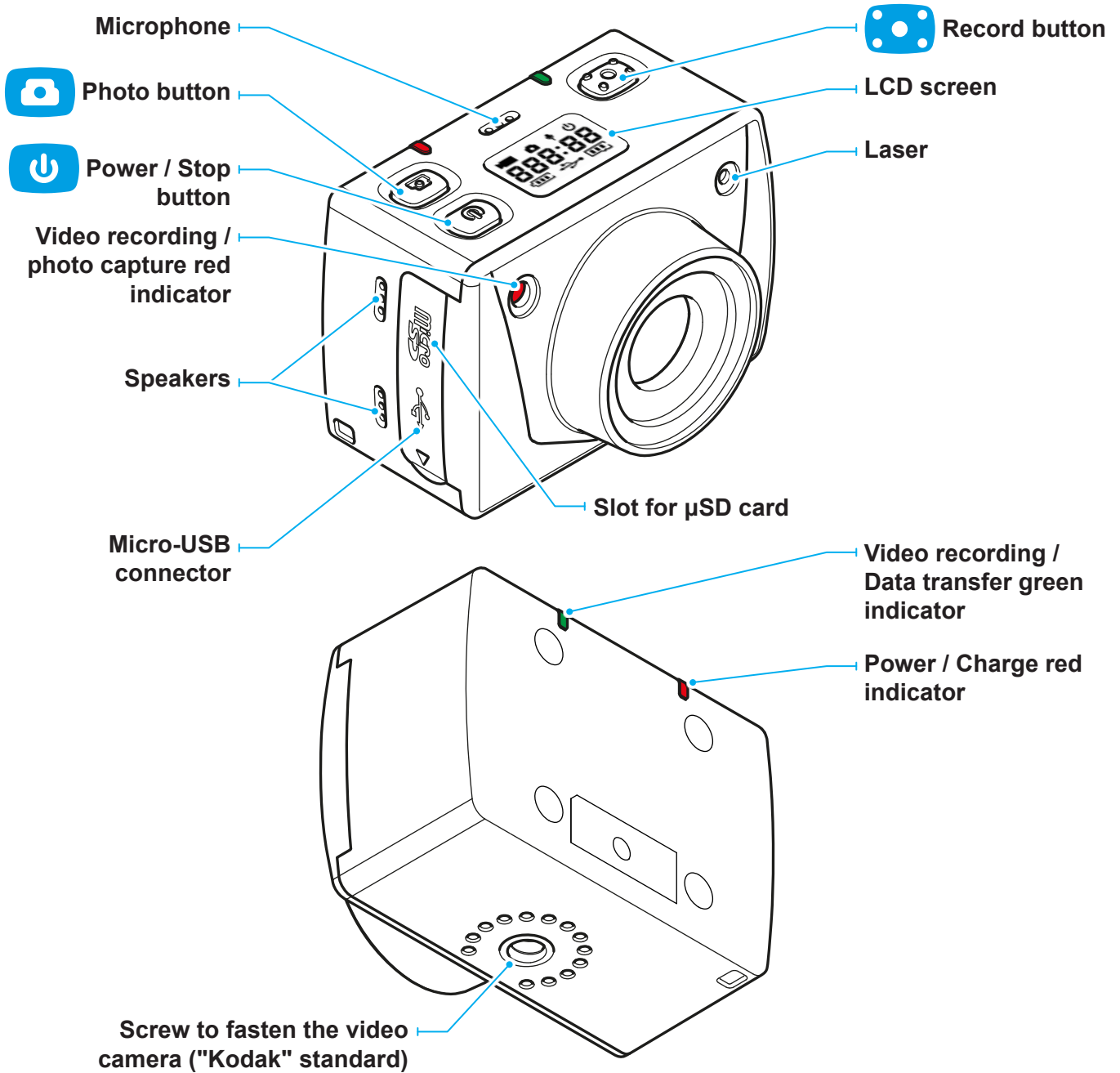

LCD SCREEN

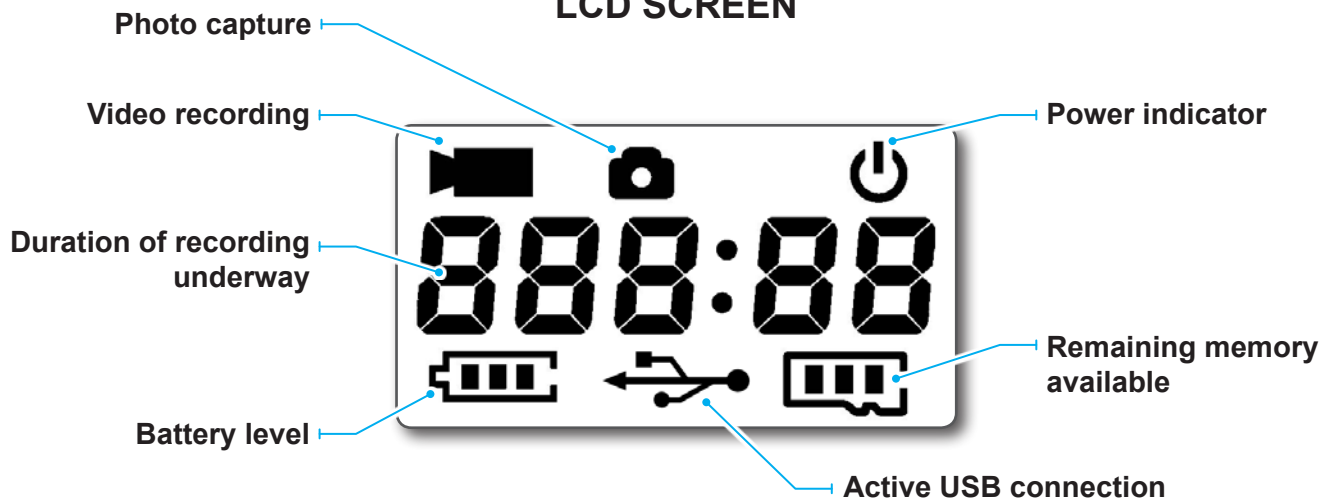

GETTING STARTED

CHARGE

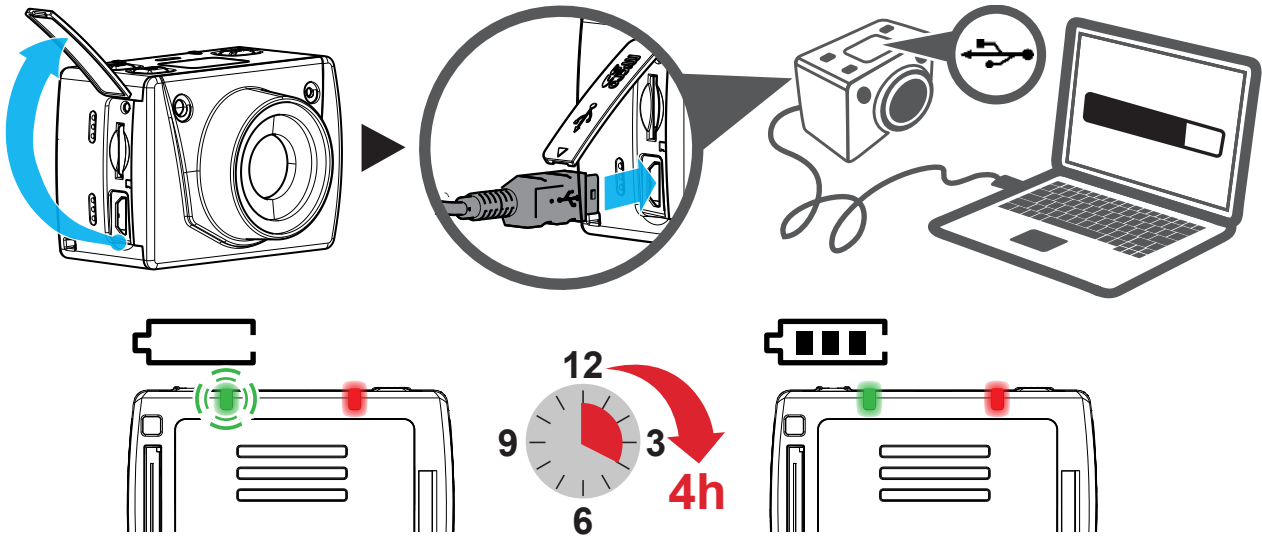

Fast Charging : When device is connected to computer, to have a more efficient charging process, you can make a long press on "power" button to shut down the camera. Then, the green LED will be powered off, and the red LED will be blinking during charging and stable when charge is completed. The charging time will be around 3 hours in that case. (Warning : data transfer is not possible during this charging mode).

INSERT MICRO-SD CARD

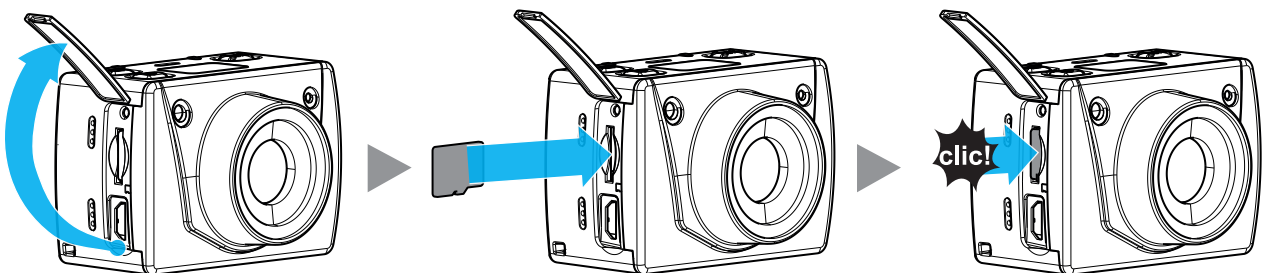

Compatible Cards

Micro-SD cards of 2GB to 32GB (Class 10 recommended)

USING YOUR G-EYE

POWER ON / OFF

POWER ON

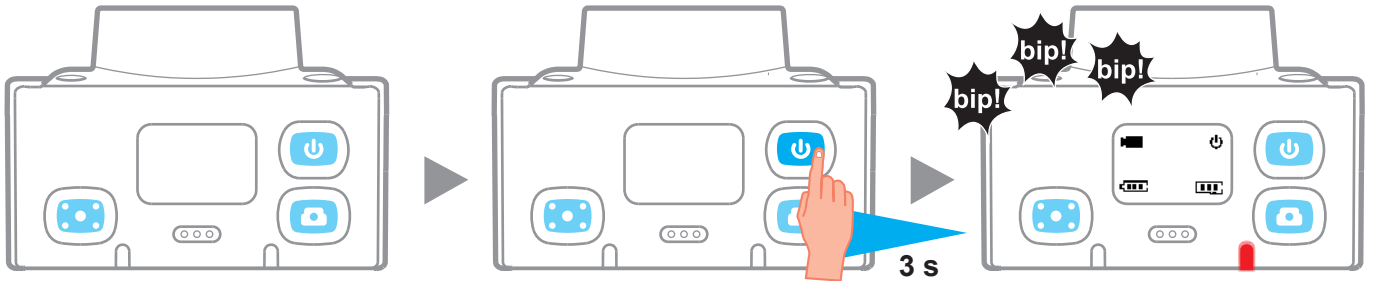

STANDBY

After 5 minutes without being used, the camera turns automatically to the standby mode.

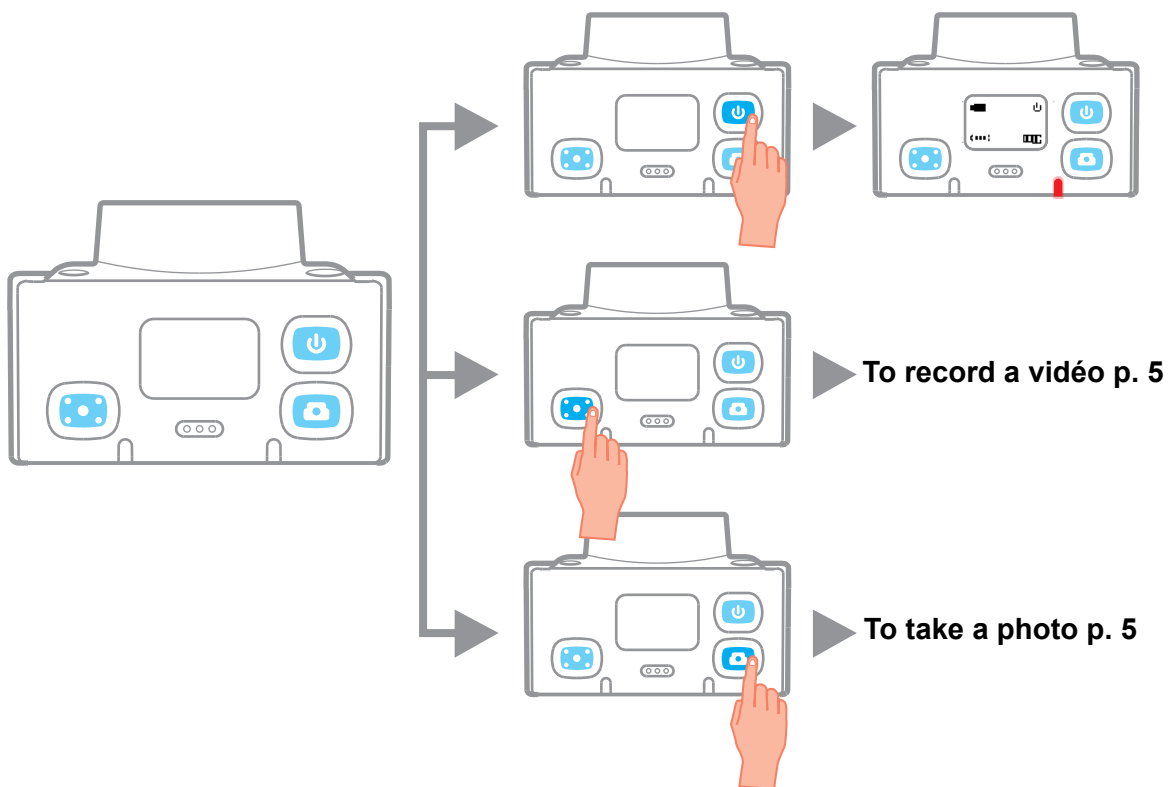

POWER OFF

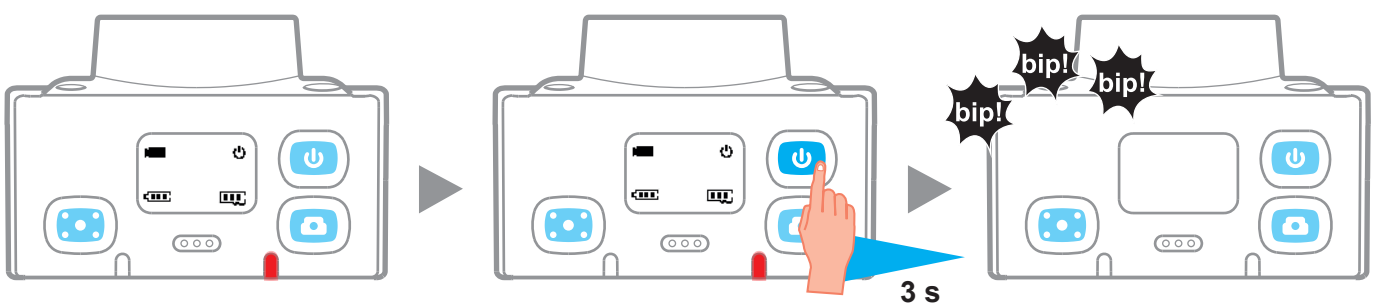

RECORD A VIDEO

START

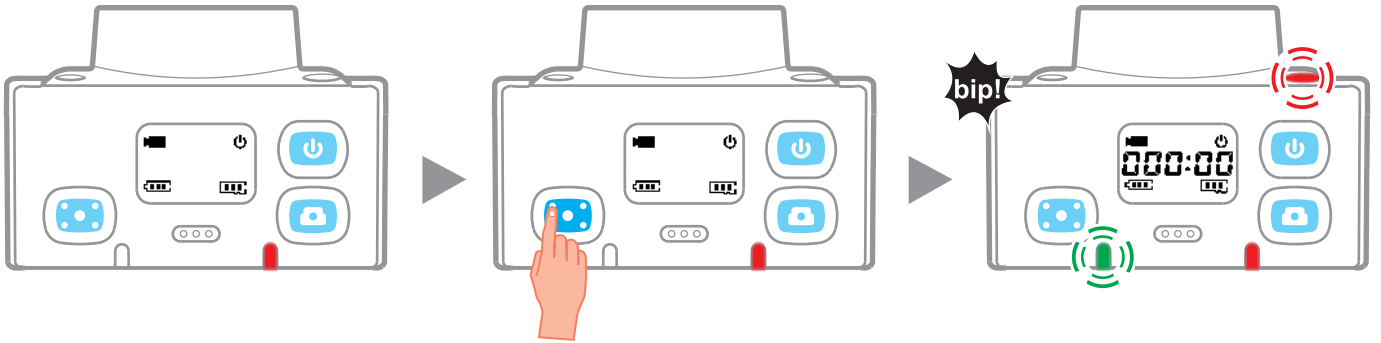

STOP

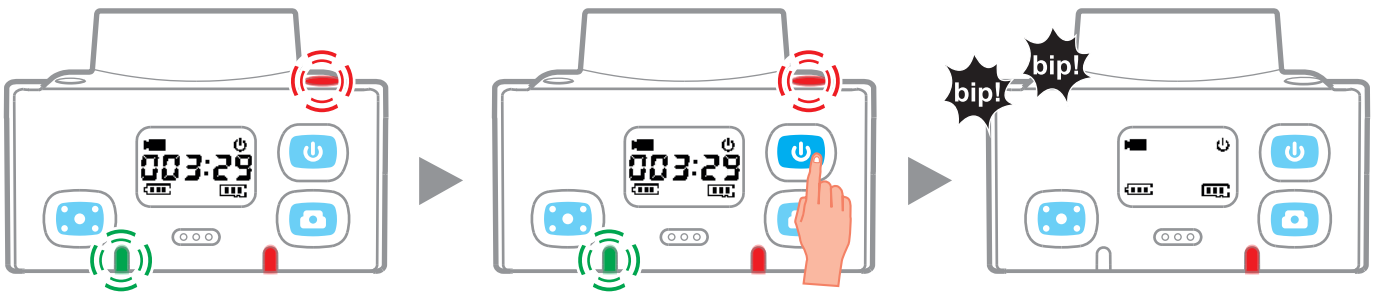

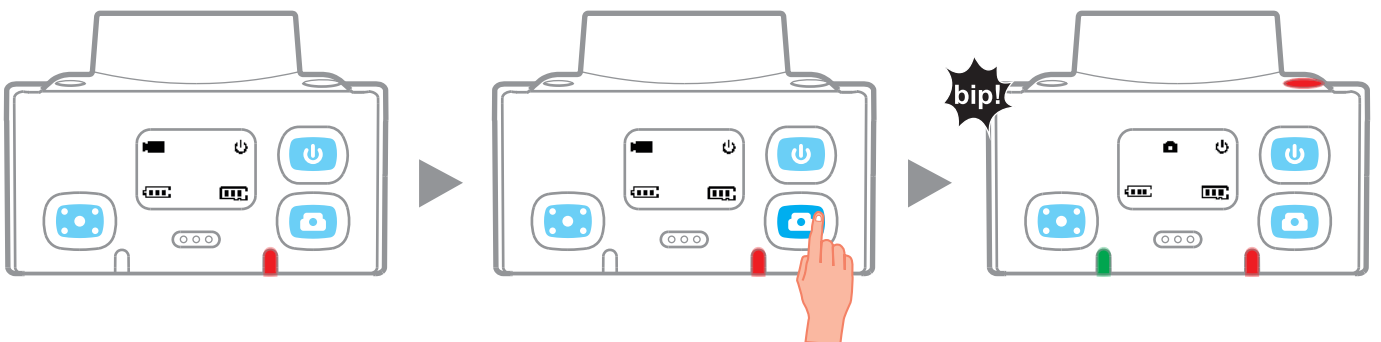

TAKE A PHOTO

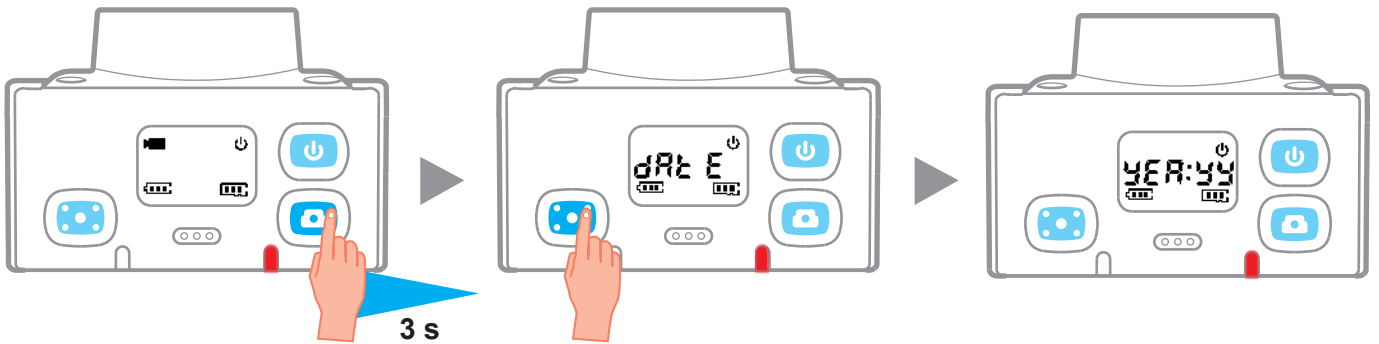

DATE AND TIME SETTING



YEA:YY	Year	For each setting:  Increase the value  Decrease the value  Validate
Mon:MM	Month	
dAY:dd	Day	
Hour:HH	Time	
Min:MM	Minute	

LASER POINTER

Laser pointer enables easy framing. It can be used with the optional waterproof cover.

ACTIVATE THE LASER POINTER

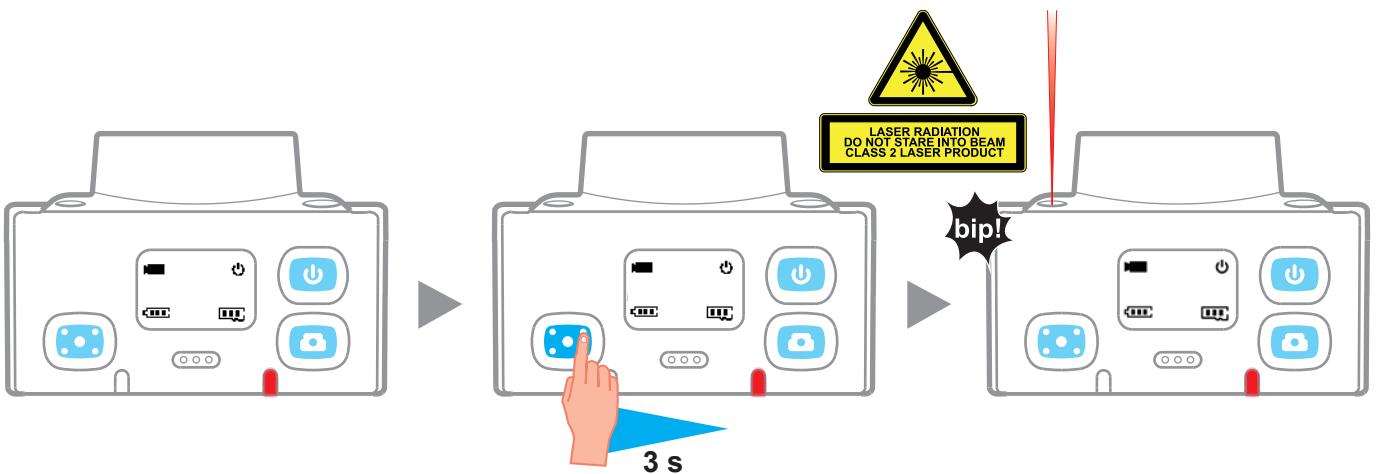

DEACTIVATE THE LASER POINTER

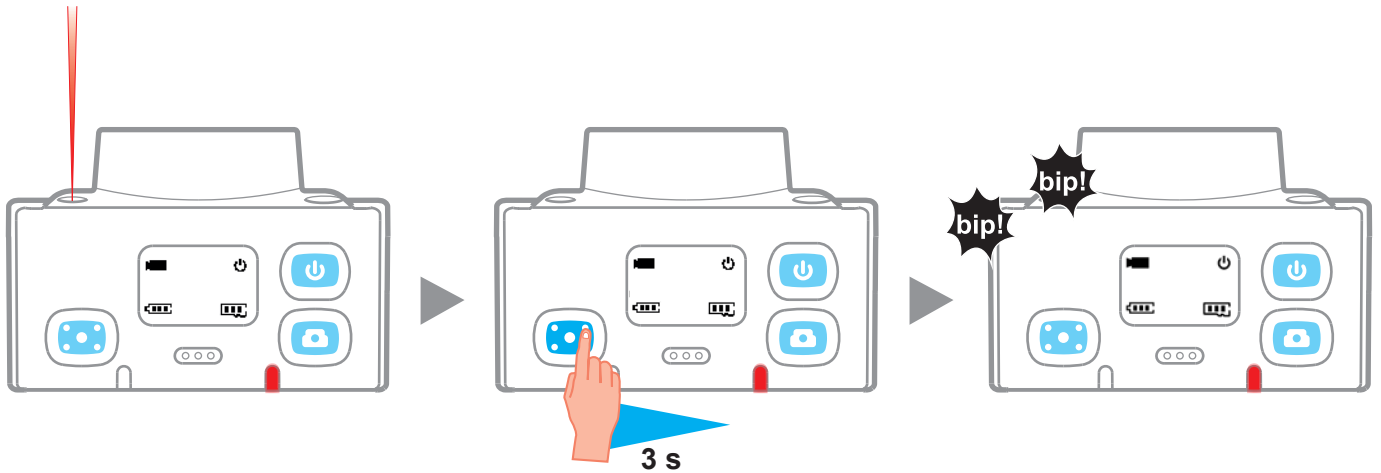

TRANSFER FILES ON COMPUTER

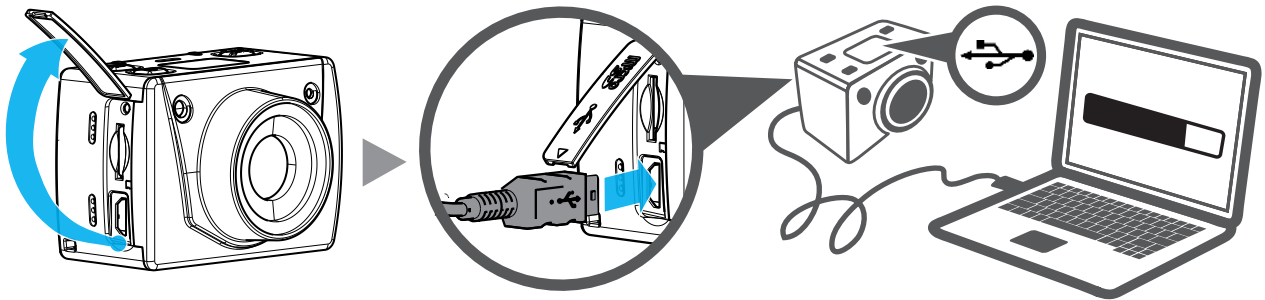

Next, recover files the same as you do with a USB key.

SYSTEM REQUIREMENTS

PC	MAC
Windows XP, Vista, 7, 8	OS > 10

RESET

If the device do not reply to any commands (button, charging, data transfer) you can reset the device to it's factory settings and it might helps it to recover. Use a small needle to press the "reset" button.

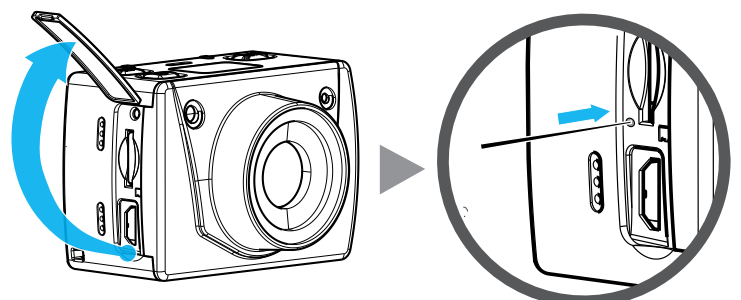

ERROR MESSAGES

MESSAGE	DESCRIPTION	ACTION
NO SD	<p>No micro-SD card inside the camera:</p> <ul style="list-style-type: none"> Impossible to start recording/capture. Possible to go to «Settings» menu. 	<p>→ <i>Insert a micro-SD card in your camera, see p. 3</i></p>
FULL	<p>Micro-SD card is full:</p> <ul style="list-style-type: none"> Impossible to start recording/capture. Possible to go to «Settings» menu. <p>bip! bip! bip! bip!</p>	<p>→ <i>Transfer videos and photos on your computer, see p. 7.</i></p>
BAT LO	<p>Low level of battery:</p> <ul style="list-style-type: none"> First, only the battery icon  is blinking. The message is displayed 2 s before the camera turns OFF. <p>bip! bip! bip! bip!</p>	<p>→ <i>Charge the battery, see p. 3.</i></p>

TECHNICAL FEATURES

Battery standby	Video continuous recording approximately 2 hours
Recharge time	~ 3.5 hours. Max < 4 hours
Battery type	Li-ion, 3.7V, 1000 mAh
Automatic sleep mode	After 5 min
Video resolution	720p, 30fps, 16:9, viewing angle = 135°
Video bitrate	8 Mps
Frame rate	50 Hz
TV standard	PAL
Photo resolution	8MP
Connectors	Micro-USB
Connection to computer	USB 2.0 « Full-Speed », card reader Micro-SD
Micro-SD card compatible (sold separately)	Micro-SD of 2 GB to 32 GB
Operational temperature	-10°C < ... < 45°C
Video format	MP4
Photo format	JPG
Language	English

PRECAUTIONS FOR USE

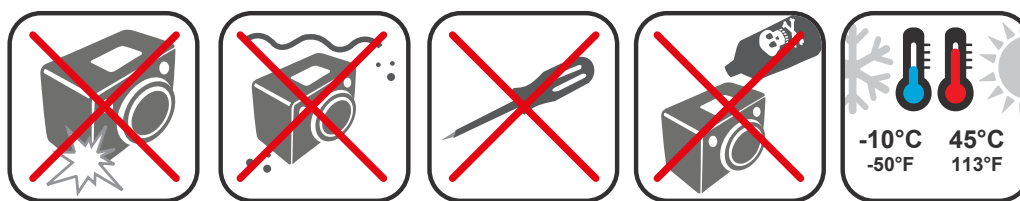

- Handle the device with care - do not drop it or subject it to strong impacts.
- This product is not waterproof, do not subject it to sprays of water or immerse it.
- For increased safety, avoid using the buttons during action. Loss of concentration can be dangerous
- Do not take the product apart, as this may lead to damage as well as cancellation of the warranty.
- Using the product in a very cold environment (temperature below -10°C) may lead to a reduction in battery capacity, and therefore reduction of battery lifetime.

WARRANTY, LEGAL WORDING

LIMITED LIABILITY

- GEONAUTE is not responsible for accidents or injuries caused by handling or using the product during high risk sports.
- In particular, GEONAUTE insists on informing the user of possible loss of concentration linked to using the product in dangerous conditions.
- The user is warned that he assumes all legal liability for the taking, sharing, and publication of images recorded with the product.

WARRANTY

- GEONAUTE guarantees the initial buyer of this product that it is exempt of defaults related to the materials or fabrication and does so for a period of 2 years (inclusive) from the date of purchase.
- Please keep your receipt as proof of purchase.
- The warranty does not cover damage caused due to improper use, non-compliance with safety precautions, accidents, or the incorrect maintenance or commercial use of the device.
- This warranty does not cover damage resulting from repairs carried out by persons not authorised by GEONAUTE.
- The guarantees contained herein explicitly replace all other guarantees including the implicit guarantee of merchantability and/or suitability for use. GEONAUTE can, under no circumstances, be held responsible for any damage, direct or indirect, of a general or specific nature, caused by or related to use of these instructions or the product they describe.
- During the warranty period, the item will either be repaired free of charge by an authorised repair service or replaced free of charge (depending on the distributor).
- The warranty does not cover the battery, or camera if it is cracked, broken or presents visible dents.

LEGAL WORDING

CE COMPLIANCE

CE OXYLANE hereby declares that the G-EYE DISCOVER device complies with essential requirements and with other relevant stipulations of the 1999/5/CE directive.

The CE compliance declaration is available at the following web link:

<https://www.geonaute.com/en/ec-declaration-conformity>

RECYCLING



This product and the batteries it contains may not be thrown away with household waste. They are subject to a specific type of sorting. Take the batteries and unusable electronic product to an authorised collection area for recycling. This treatment of your electronic waste will protect the environment and your health.

CONTACT US

Contact us on www.geonaute.com.